

TITLE: FOLDING SHELF MODULE ASSEMBLY		
DOCUMENT #: <b>WI-FOLD SHELVING ASSY</b>	LABOR HOURS: <b>1.0</b>	PRINT DATE: <b>1/10/25</b>
REVISION: <b>1</b>	PREPARED BY: <b>RAM KISHORE</b>	DATE PREPARED: <b>1/09/25</b>
EFFECTIVE DATE: <b>-</b>	REVIEWED BY: <b>M. McClelland</b>	DATE REVIEWED: <b>-</b>
FUNCTIONAL DEPARTMENT: <b>ENGINEERING</b>	APPROVED BY: <b>M. McClelland</b>	DATE APPROVED: <b>-</b>

**STANDARD WARNINGS:**

- READ WORK INSTRUCTIONS IN ENTIRETY BEFORE STARTING
- CHECK THAT YOU ARE PROPERLY CLEAR OF GAS TANK AND WIRES BEFORE DRILLING
- CONTACT ENGINEERING IF QUESTIONS ARISE OR DOCUMENT NEEDS TO BE UPDATED
- FOLLOW ALL LISTED OEM SYSTEM FUNCTIONALITY CHECKS AFTER INSTALL.

**PART IDENTIFICATION / BOM:**

PART NUMBERS	DESCRIPTION	QTY-UM
• 0ALU991	SHLF ASM FLDG 45X18	1.0000 EA
• 0ALU977	PNL SHLF 45X18	1.0000 EA
• 0ALU979	ARM SHELF 18	4.0000 EA
• 0ALU976	SUPT BRKT SHLF SIDE 16	2.0000 EA
• 0ALU973	SUPT BRKT SHLF FR45	2.0000 EA
• RM540340	RIVET BLIND 1/4"X1/2" SS	62.000 EA
• RM520190	NUT ESH 5/16-18	6.0000 EA
• RM541081	WASHER FLAT 5/16	6.0000 EA
• RM518020	STUD BALL THD 10X.31-18X1.60A	6.0000 EA
• 0ALU990	SHLF ASM FLDG 45X20	1.0000 EA
• 0ALU975	PNL SHLF 45X20	1.0000 EA
• 0ALU974	SUPT BRKT SHLF SIDE 18	2.0000 EA
• 0ALU995	UPR FLDG SHLF ASM & BRKT	2.0000 EA
• 0ALU987	UPR SHELF STAND 54.5	1.0000 EA
• 0ALU959	BRKT SHLF BPR	2.0000 EA
• 0ALU985	BRKT SHELF LH	2.0000 EA
• 0ALU986	BRKT SHELF RH	2.0000 EA
• 0ALU984	SHIM SHELF BRKT	4.0000 EA
• 02T146	PLUG BPR D/R	2.0000 EA
• 02R176	GAS SPRING 60LB 8.7/6.2	2.0000 EA
• RM521209	NUT ESH 3/8-16	8.0000 EA
• RM541082	WASHER FLAT 3/8	12.000 EA
• RM511511	SCREW HHC 3/8-16X1.25	4.0000 EA

- RM510676 BLT SHLDR 5/16X2-1/2 1/4-20 2.0000 EA
- RM520227 NUT NYLOC 1/4-20 SS 2.0000 EA
- RM541061 WASH.25" USS FLAT ZINC 2.0000 EA
- RM510679 SCREW 3/8-16 X 3-1/4" HEX HEAD 4.0000 EA
- 0ALU962 SHLF MTG CHNL 4FT 3.0000 EA
- 02T147 HDW BAG FLDG SHLF 4&6FT 1.0000 EA
- RM420032 CTN RSC 51X41X19.875 71 ECT BC 1.0000 EA

**TOOLS REQUIRED:**

- Impact Driver
- 1/4" Rivet Gun
- 5/16" Wrench
- 3/8" Wrench

**TORQUE TABLE**

SIZE	TIGHTENING TORQUE
1/4-20 (.250)	12 in lbs.
5/16-18 (.3125)	25 ft lbs.
3/8-16 (.375)	44 ft lbs.

**KIT PACK**

- FOLDING SHELVEING PACK 45" (1)

**SUB-ASSEMBLY**

- FOLDING SHELF UPRIGHT (LH&RH) – 0ALU995 (2)

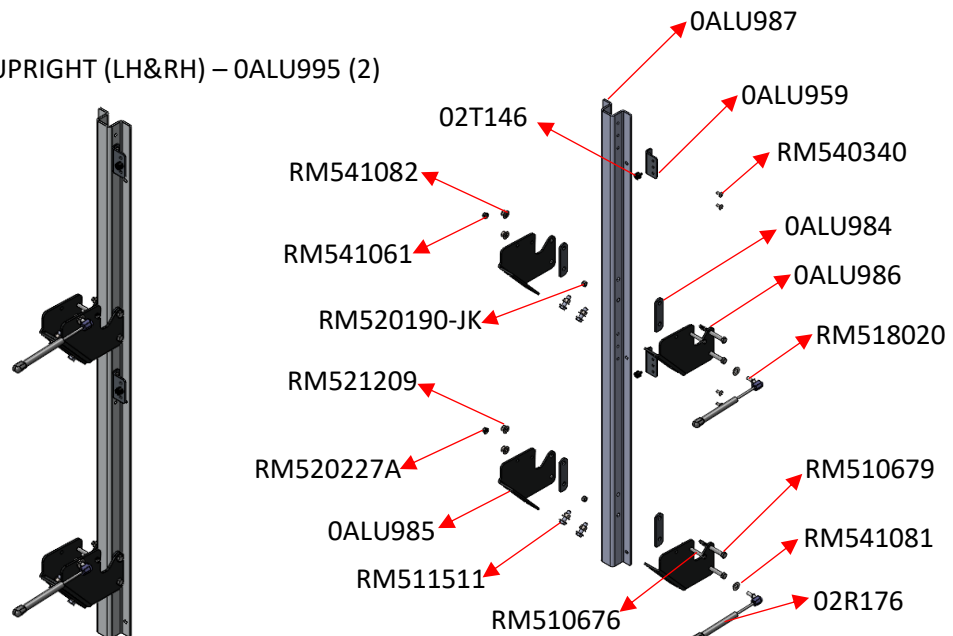

- FOLDING SHELF ASSEMBLY 45X18" -OALU991(1)

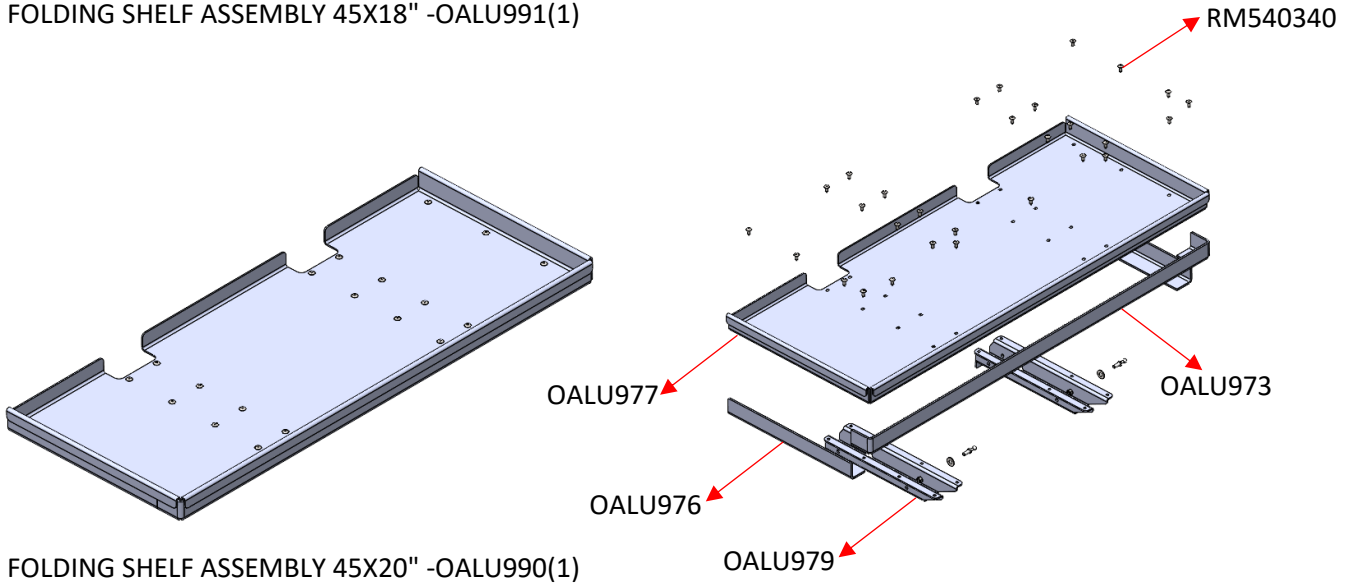

- FOLDING SHELF ASSEMBLY 45X20" -OALU990(1)

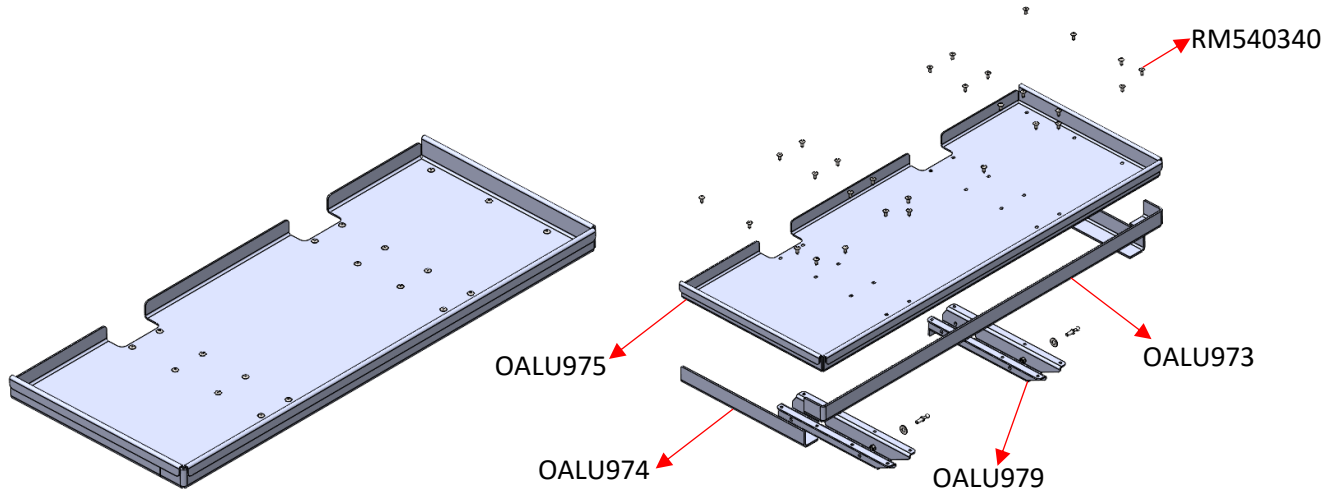

- FOLDING SHELF VAN MOUNT BRK -OALU962(3)

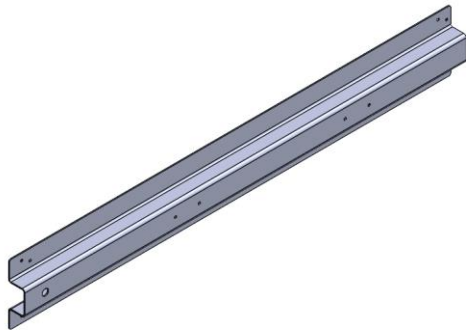

- FOLD FLAT HD HARDWARE BAG (1) - 02T147

**MODULE ASSEMBLY:**

- Lay the **FOLDING SHELF UPRIGHTS** Assemblies down on the workbench and ensure that they are parallel, squared, and aligned with each other.
- Attach (2) **FOLDING SHELF ASSY** to the (2) **UPRIGHT ASSEMBLY** at two positions Using (4) **BLT SHLDR 5/16X2-1/2 1/4-20**, (4) **WASH.25" USS FLAT ZINC**, (4) **NUT NYLOC 1/4-20 SS**.

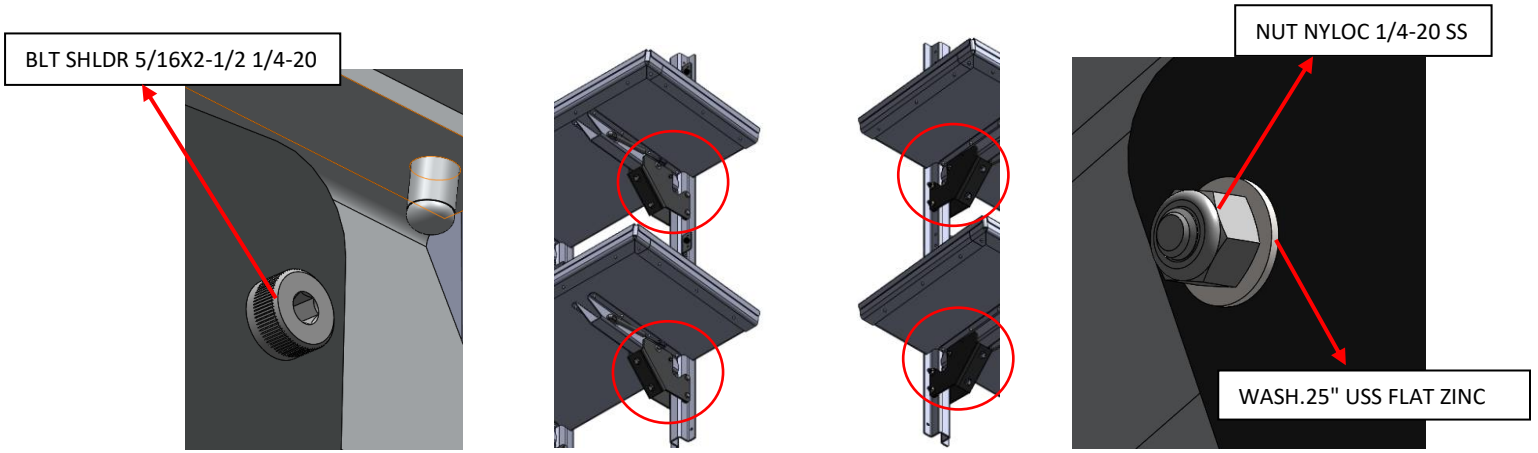

- Connect the free end of **GAS SPRING TO SHELF ARM (2)** with help of **STUD BALL THD 10X.31-18X1.60A (8)**, **WASHER FLAT 5/16(8)**, **NUT ESH 5/16-18(8)**

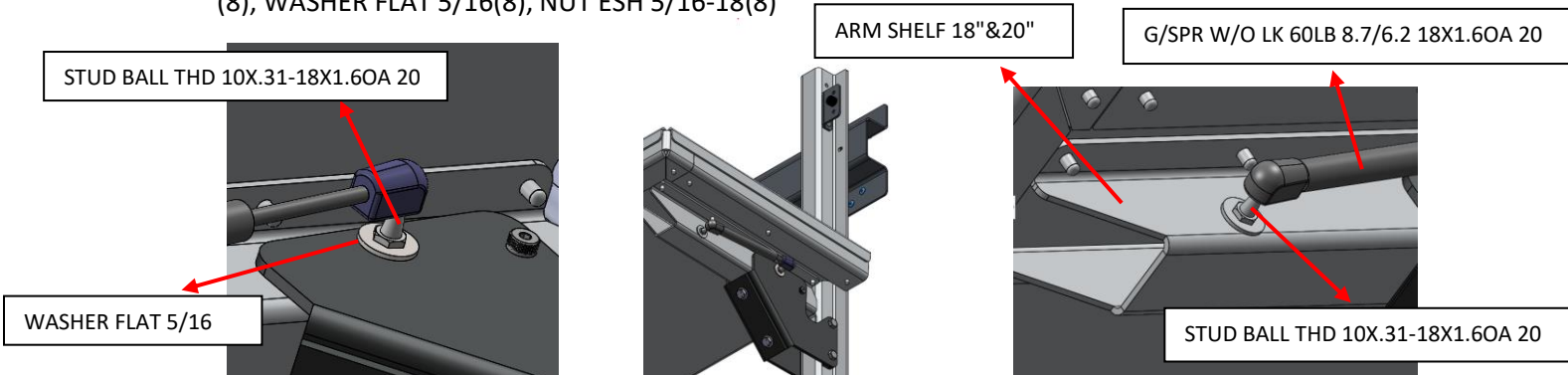

**NOTE:** One end of **GAS SPRING** is already connected to **FOLDING SHELF UPRIGHTS**

- Connect The **FOLDING SHELF VAN MOUNT BRKT** With **UPRIGHT ASSEMBLY WITH FOLDING SHELVINGS** by using rivets **RIVET BLIND 1/4"X1/2" SS (12)**.

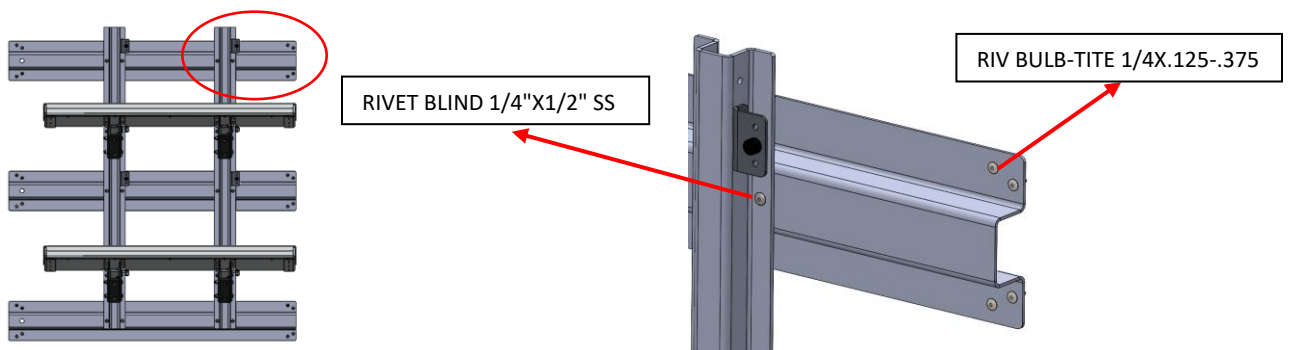

**NOTE: To connect van mount bracket with van body, use RIV BULB-TITE 1/4X.125-.375 (24)**

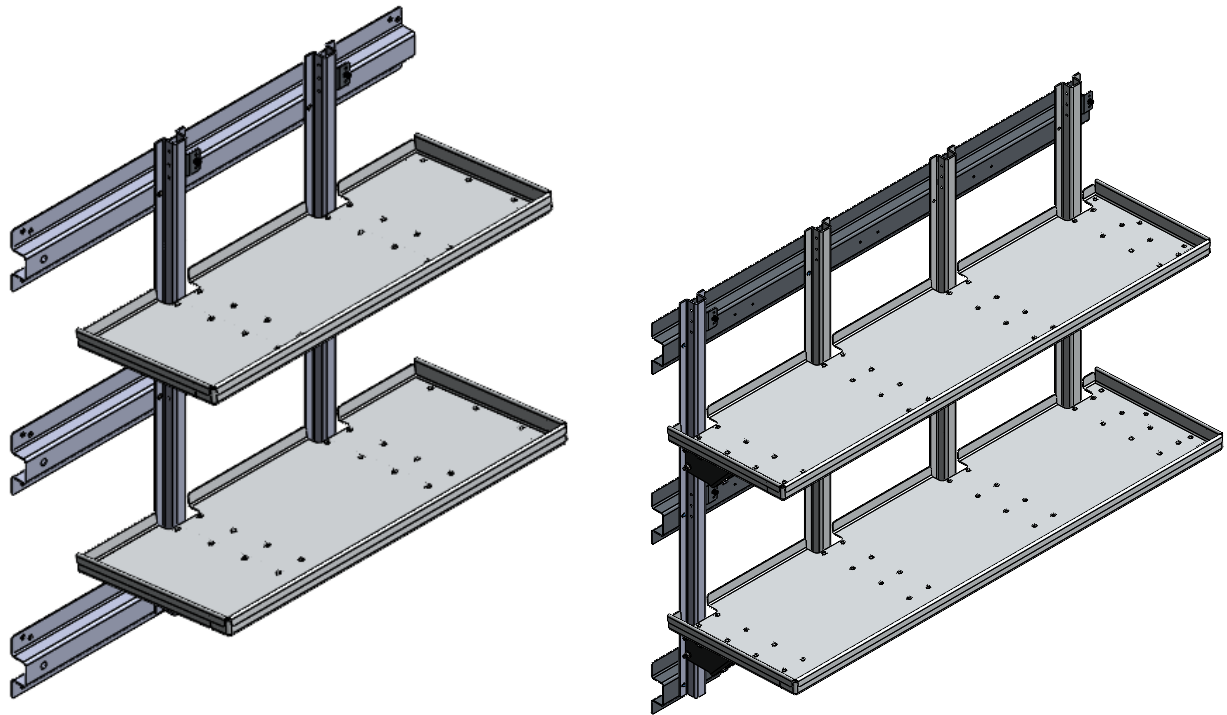

**TABLE**

	<b>FOLDING SHELF 45 0ALU98KP</b>	<b>FOLDING SHELF 68 0ALU99KP</b>
<b>FOLDING SHELF UPRIGHT (LH&amp;RH)</b>	<b>0ALU995</b>	<b>0ALU995</b>
<b>FOLDING SHELF UPRIGHT (LH, RH)</b>	-	<b>0ALU996</b>
<b>FOLDING SHELF ASSY</b>	<b>0ALU991,0ALU990</b>	<b>0ALU993,0ALU992</b>
<b>FOLD FLAT SHELF BRACE</b>	<b>0ALU973</b>	<b>0ALU978</b>
<b>FOLDING SHELF VAN MOUNT BRK</b>	<b>0ALU962</b>	<b>0ALU961</b>
<b>FOLD FLAT HD HARD BAG</b>	<b>02T147</b>	<b>02T147</b>

NOTE: -

1. HIGHLIGHTED PARTS AND SUBASSEMBLIES IN THE ABOVE TABLE ARE COMMON ACROSS ALL MODULES OF FOLDING SHELVINGS
2. NON-HIGHLIGHTED PARTS AND SUBASSEMBLIES IN THE ABOVE TABLE ARE NON-COMMON ACROSS ALL MODULES OF FOLDING SHELVINGS

**BEFORE DRILLING**

**STOP**      CHECK ALL MOUNTING LOCATIONS TO PREVENT PENETRATING GAS LINES, GAS TANKS, BRAKE LINES, WIRING OR ANY OTHER STRUCTURE OF VEHICLE      **STOP**

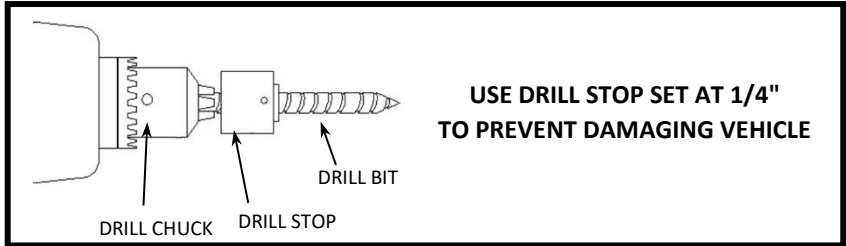

The Plusnut® is pre-bulbed for easy installation

**1**



The Plusnut® is pre-assembled with hex cap and hex bolt. Then it is inserted into a pre-drilled hole

**2**

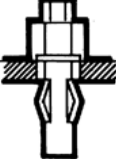

As the bolt is tightened, the Plusnut® upsets and provides outstanding blind fastening holding power

**3**



C-500 tool tightens bolt thru hex head cap into Plusnut® A ratchet, open-end or closed –end wrench can be used.

**4**



Fully upset Plusnut® provides a reliable nut plate for fastening.

**5**