

(ALUMINIUM CORE SHELVINGS 46" & 60" MODULE)

Recommended Tools

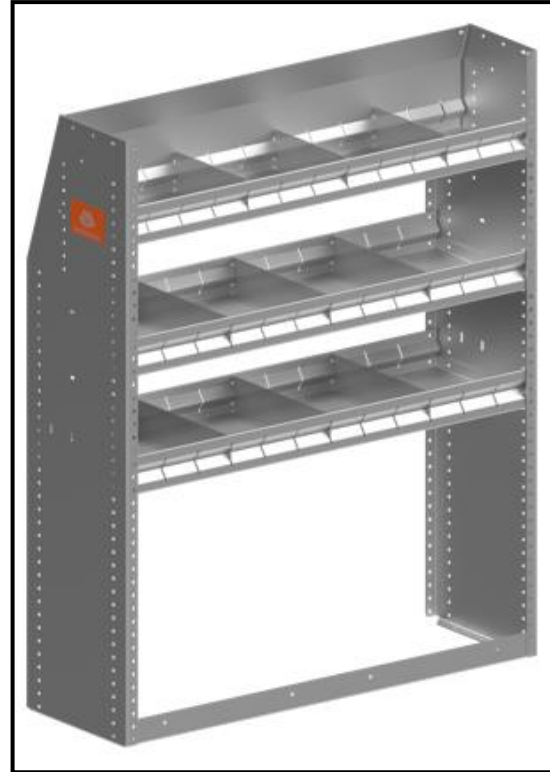

Hardware

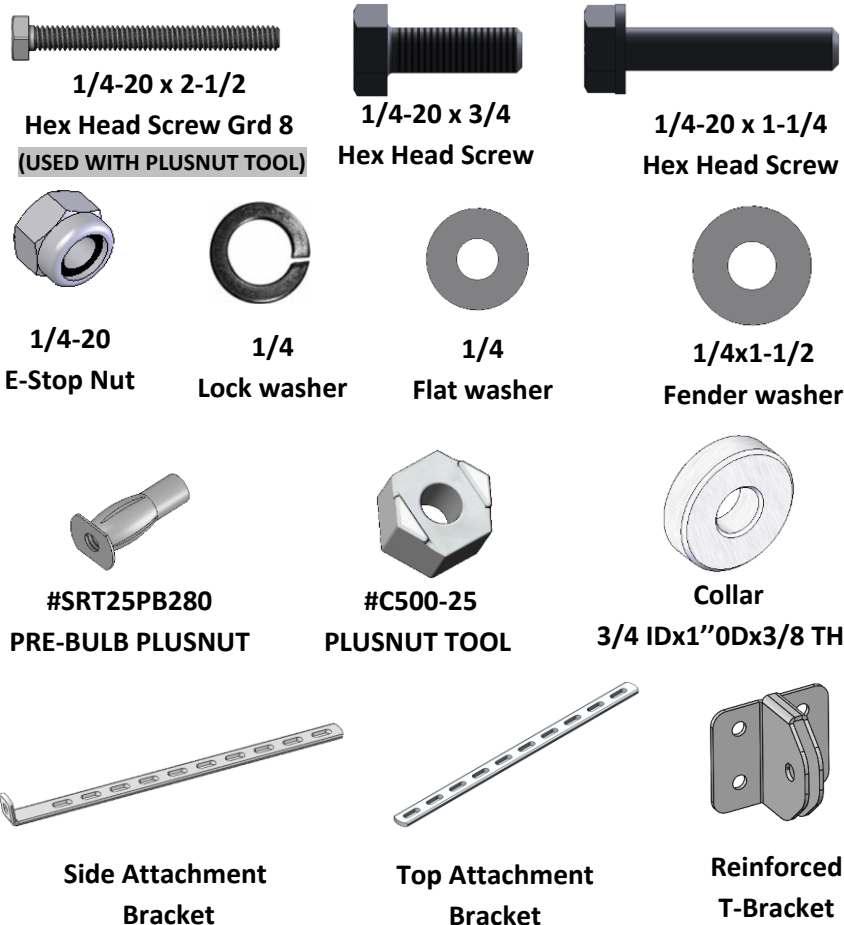

TAPERED MODULES 46"

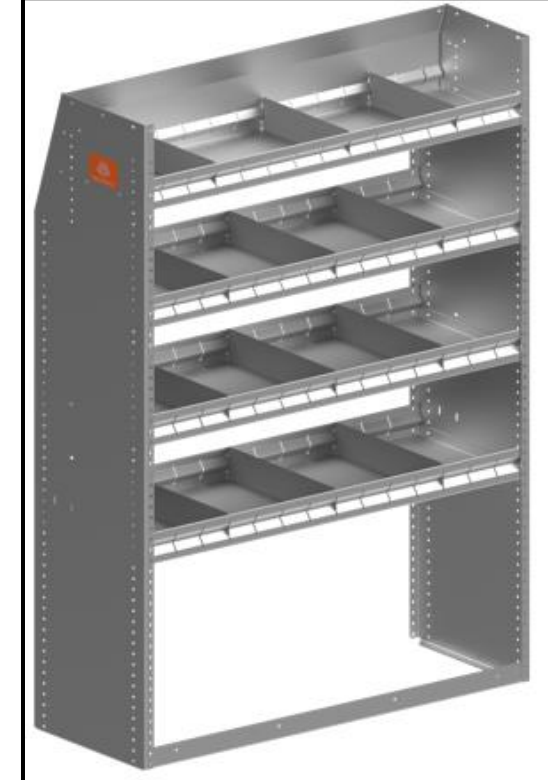

TAPERED MODULES 60"

Review this document to ensure that all parts and hardware are included in the package, before installation. In the event that parts are missing please contact Masterack @ 1-800-222-8785, to re-order missing parts.

EXPLODED VIEW

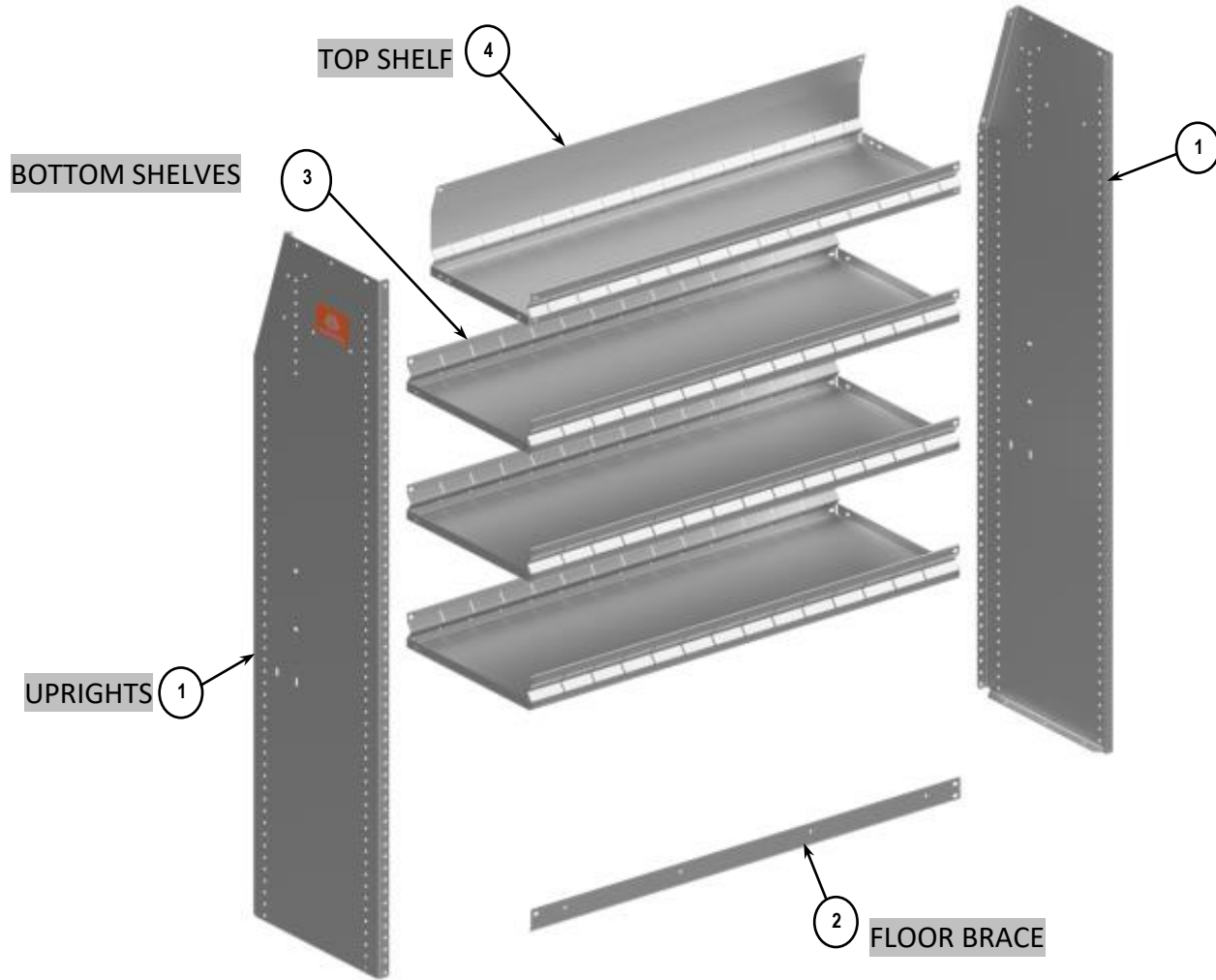

COMPONENTS

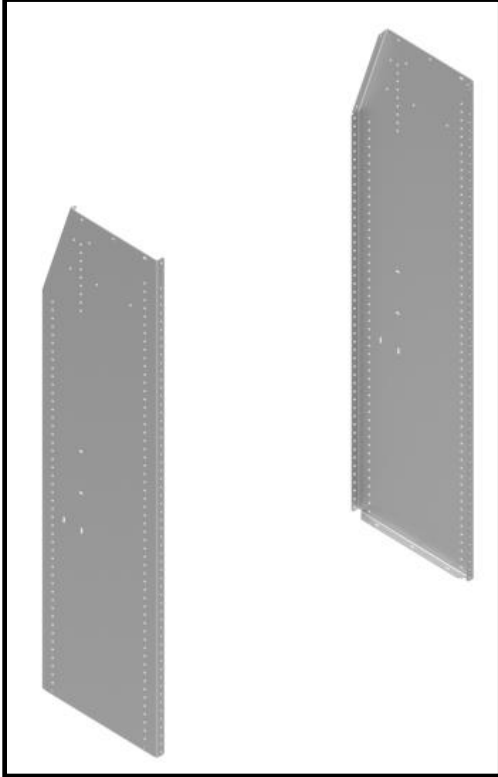

1 TAPERED UPRIGHT (SET OF 2)

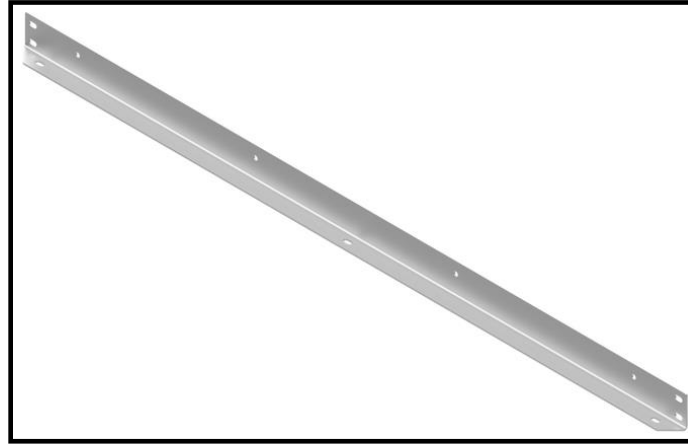

2 FLOOR BRACE



4 TOOL DROP TRAY



3 BOTTOM SHELVES

SHELVING MODULE	UPRIGHTS (L & R SET) ①	FLOOR BRACE ②	BOTTOM SHELVES ③	TOOL DROP TRAY ④
46-INCH-TALL MODULES				
0ALU038KP [46H x 43W x 16D]	0ALU066	0ALU042	0ALU041 – QTY. 2	0ALU069
0ALU048KP [46H x 37W x 16D]	0ALU066	0ALU049	0ALU050 – QTY. 2	0ALU053
0ALU044KP [46H x 43W x 12D]	0ALU068	0ALU042	0ALU040 – QTY. 2	0ALU046
0ALU052KP [46H x 37W x 12D]	0ALU068	0ALU049	0ALU051 – QTY. 2	0ALU003
60-INCH-TALL MODULES				
0ALU054KP [60H x 43W x 16D]	0ALU067	0ALU042	0ALU041 – QTY. 3	0ALU069
0ALU057KP [60H x 37W x 16D]	0ALU067	0ALU049	0ALU050 – QTY. 3	0ALU053

ATTACHING FLOOR BRACE

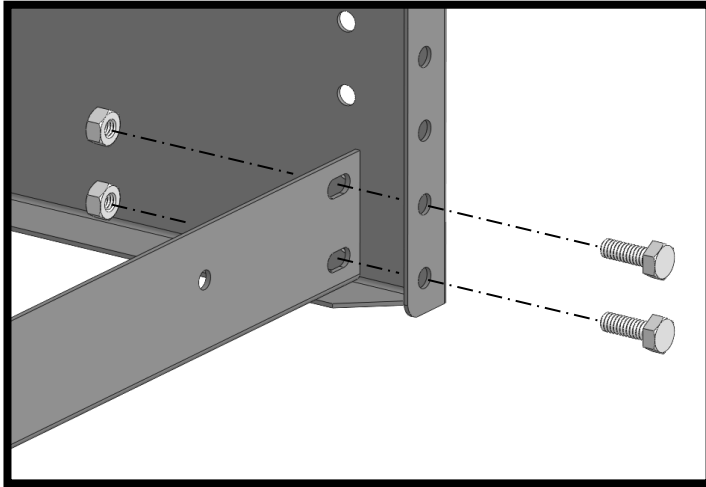

Attach as shown using:
(4) 1/4-20 x 3/4 Hex Head Screws
(4) 1/4-20 E-Stop Nuts

TORQUE SETTING:
Size - 1/4 = 7 - 9.5 Ft.-Lbs.

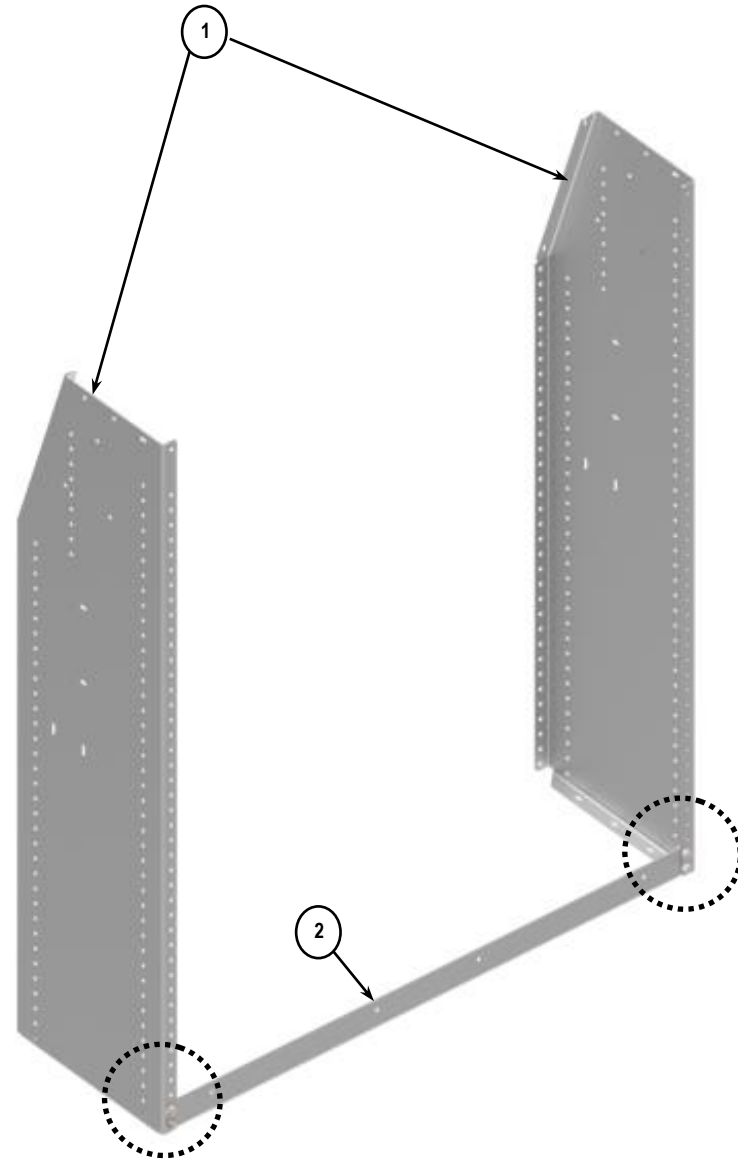

ATTACHING BOTTOM SHELF

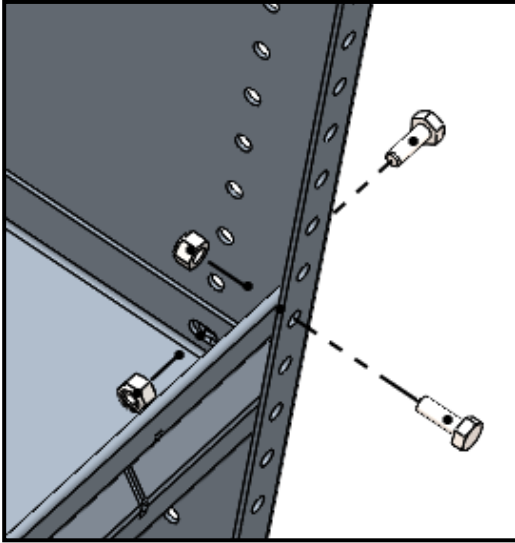

Attach Shelf as shown, using:
(8) 1/4-20 x 3/4 Hex Head Screws
(8) 1/4-20 E-Stop Nuts

TORQUE SETTING:
Size - 1/4 = 7 - 9.5 Ft.-Lbs.

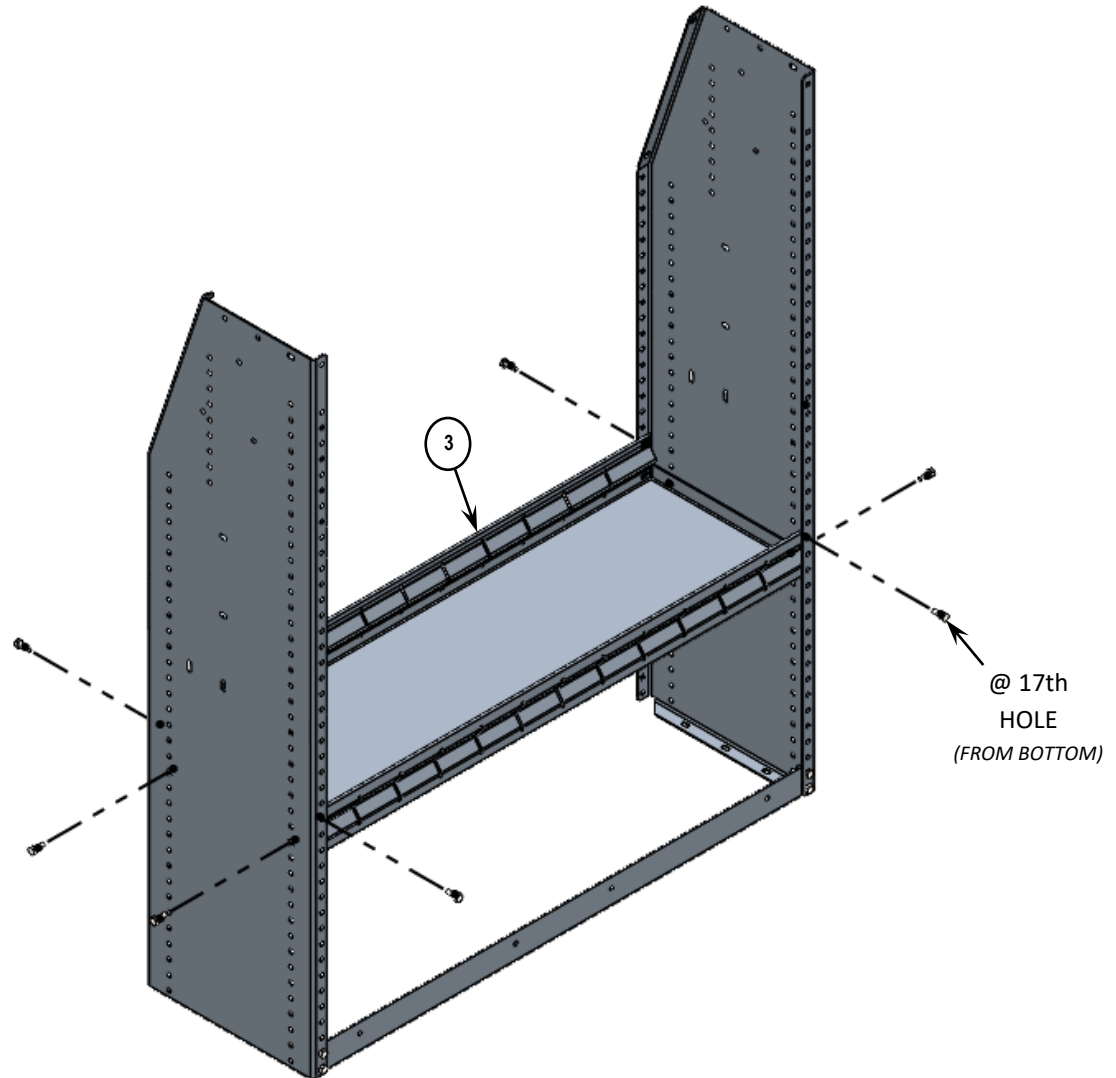

APPLICABLE TO 46" MODULES

ATTACHING REMAINING SHELVES

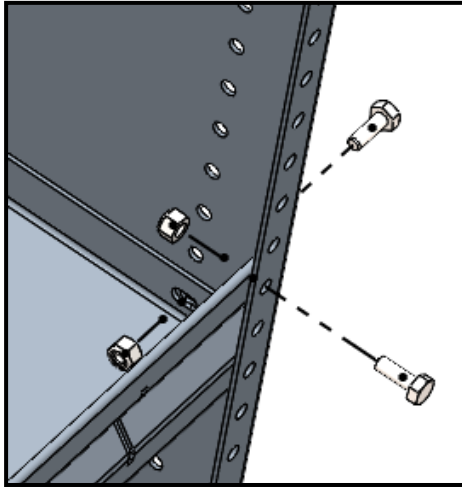

Attaching (2) Shelves as shown, using:
(16) 1/4-20 x 3/4 Hex Head Screws
(16) 1/4-20 E-Stop Nuts

TORQUE SETTING:

Size - 1/4 = 7 - 9.5 Ft.-Lbs.

NOTE:

SHELVES ARE ADJUSTABLE TO FIT REQUIRED NEED.
MOUNTING LOCATIONS SHOWN ARE STANDARD
MOUNTING LOCATIONS 12 INCHES APART.

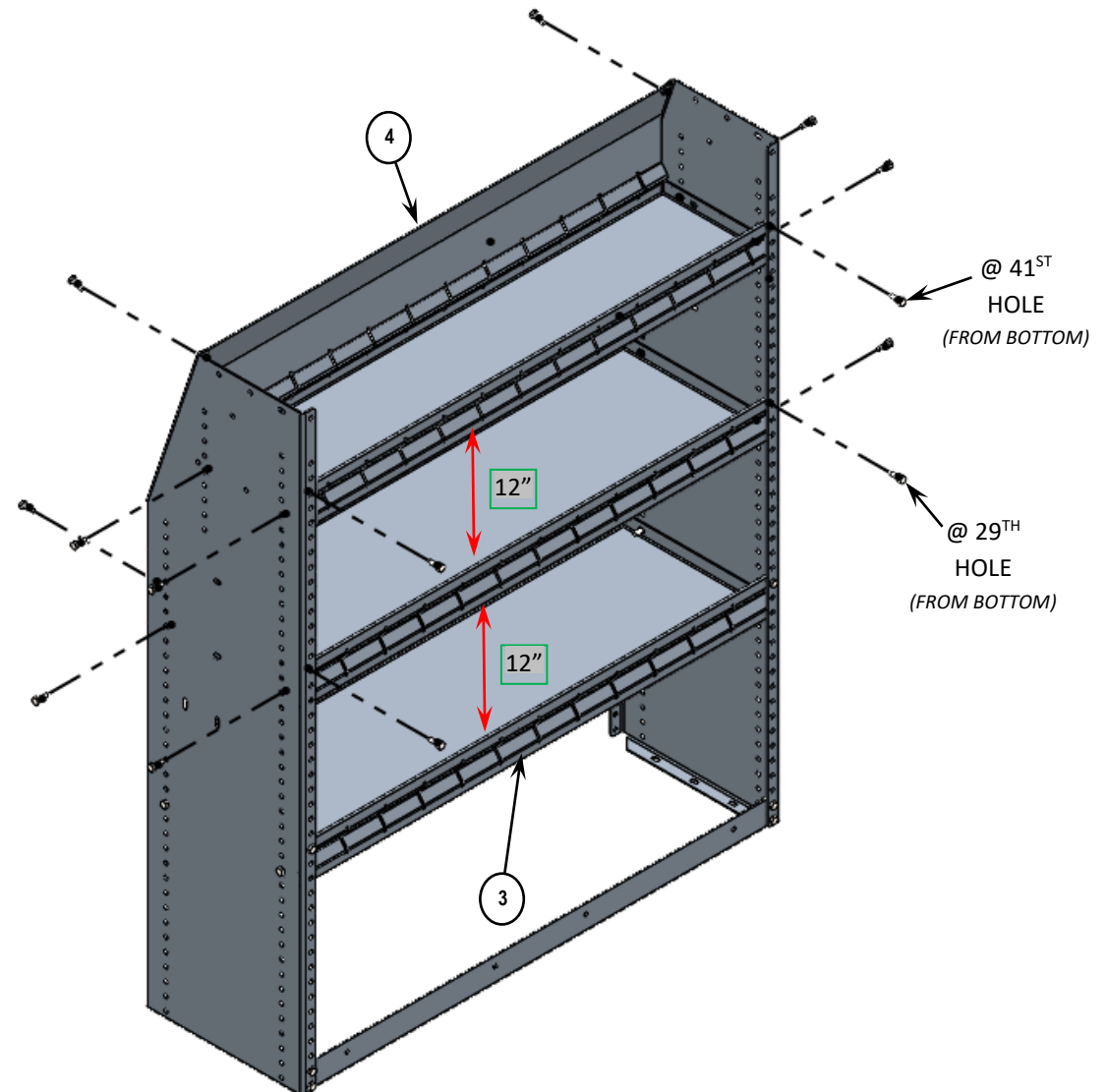

APPLICABLE TO 60" MODULES

**ATTACHING
REMAINING SHELVES**

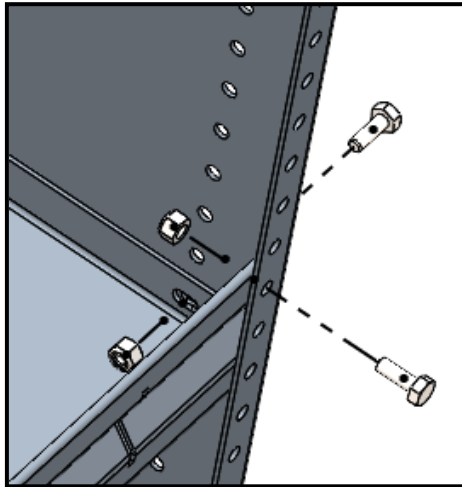

Attaching (3) Shelves as shown, using:
(20) 1/4-20 x 3/4 Hex Head Screws
(20) 1/4-20 E-Stop Nuts

TORQUE SETTING:
Size - 1/4 = 7 - 9.5 Ft.-Lbs.

NOTE:
SHELVES ARE ADJUSTABLE TO FIT REQUIRED NEED.
MOUNTING LOCATIONS SHOWN ARE STANDARD
MOUNTING LOCATIONS 12 INCHES APART.

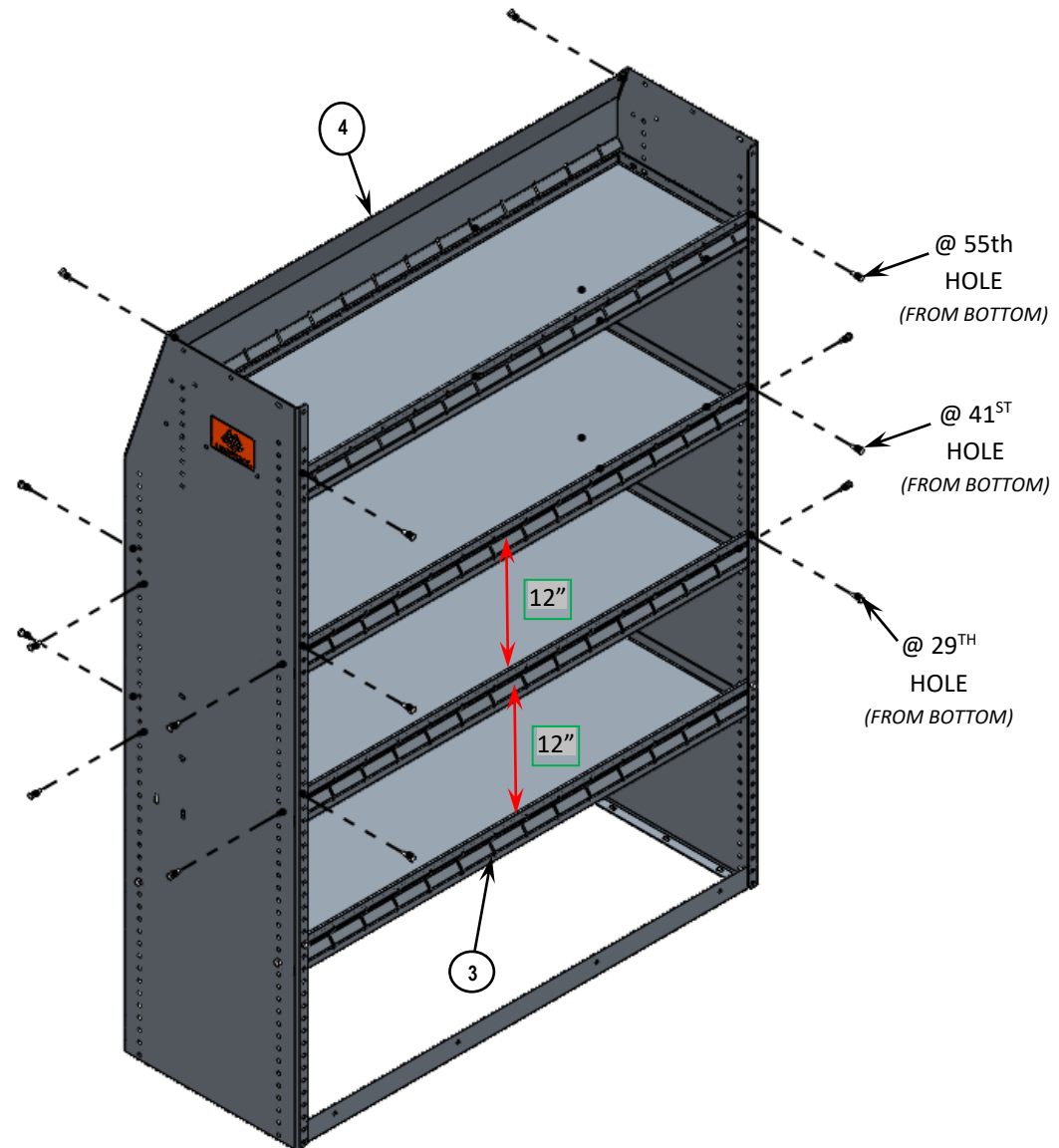

STANDARD INSTALLATION

BEFORE DRILLING

STOP CHECK ALL MOUNTING LOCATIONS TO PREVENT PENETRATING GAS LINES, GAS TANKS, BRAKE LINES, WIRING OR ANY OTHER STRUCTURE OF VEHICLE **STOP**

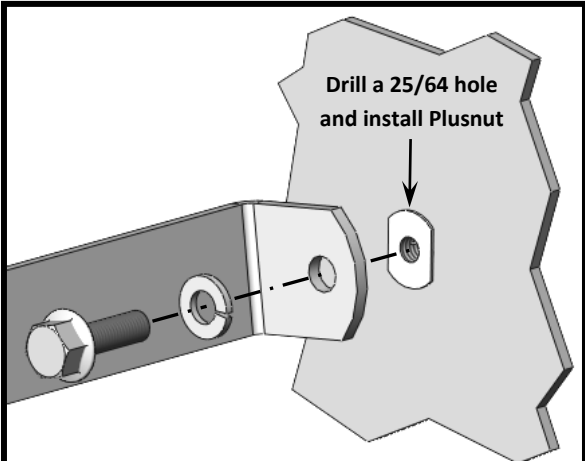

Drill a 25/64 hole and install Plusnut

With module properly positioned in desired location in vehicle, attach brackets loosely at the locations shown. Mark and drill 25/64 holes to install Plusnuts and secure as shown using:

- (1) 1/4-20 x 1 1/4 Hex Head Screws
- (1) 1/4-20 Lock Washer

AT EACH MOUNTING LOCATON

TORQUE SETTING:
Size - 1/4 = 7 - 9.5 Ft.-Lbs.

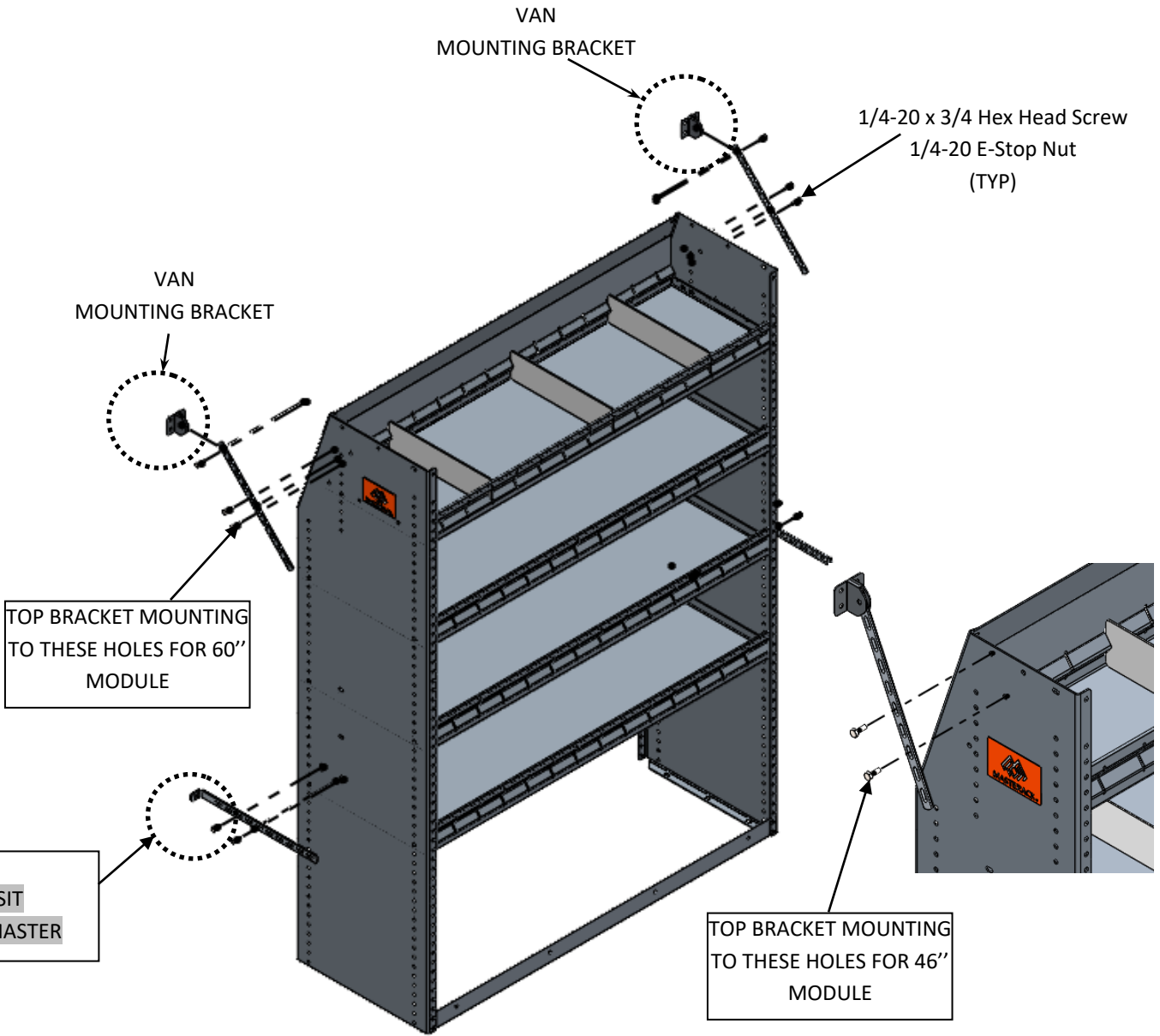

STANDARD INSTALLATION T-BRACKET

Please read this entire instruction sheet before working on your vehicle and observe the following safety considerations at all times while installing the T-Bracket:

Wear safety glasses at all times during installation!

Carefully examine behind any drilling location for any electrical wiring. Use a drill stop if necessary to prevent drill bits from penetrating roof or side body panels.

STEP 1

Mark four pilot holes in the upper side rib using the T-Bracket (Item 1) as a template. Remove the T-Bracket and drill 3/8" pilot holes. Install (4) PRE-BULB PLUSNUTS (Item 2) in the 3/8" pilot holes. Use a 1/4-20 X 2-1/2" screw (Item 4) to set the plusnut. **SEE PAGE 15** for detailed PLUSNUT installation.

Required Tools

Electric Drill

3/8" drill bit

3/8" drill stop

7/16" wrench or socket

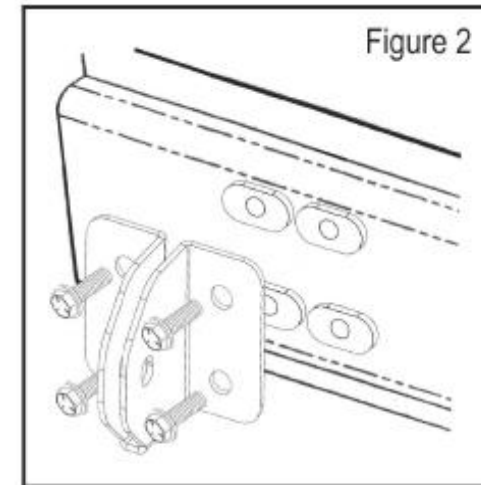

STEP 2

Attach the T-Bracket using (4) 1/4-20 X 3/4" screw (Item 5). See Figure 2.

STEP 3

Connect the attachment brace through the middle of the T-bracket using (1) 1/4-20 X 3/4" screw and (1) 1/4-20 elastic stop nut. See Figure 3.

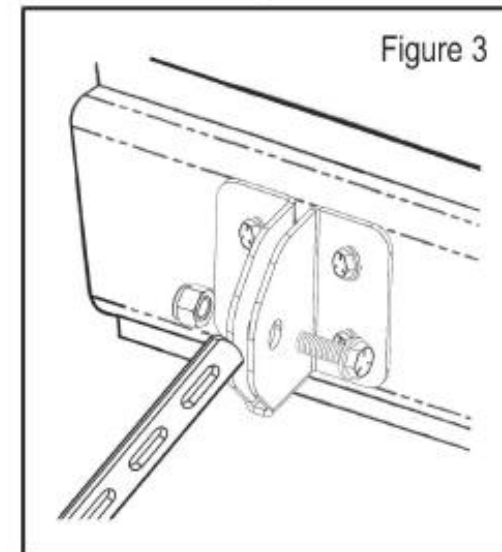

STANDARD INSTALLATION

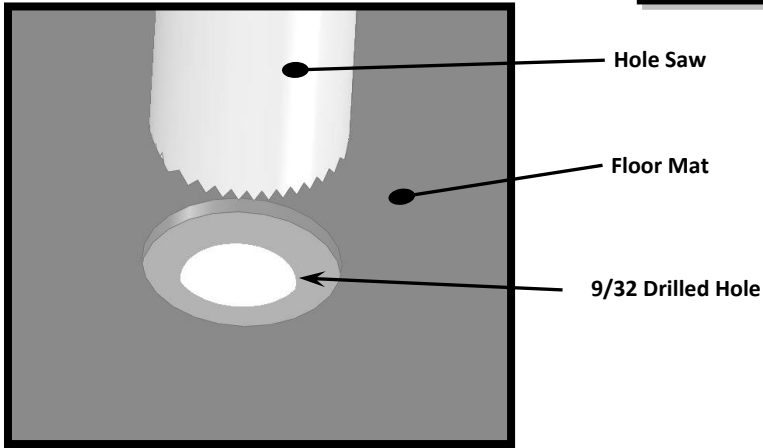

NOTE:

Using a 1-1/8" Hole Saw specially made for mat cutting, hole saw out all holes in the mat making sure to align hole saw with pre drilled holes. **Make sure not to drill through the metal floor of the van.** Once drilled clear out each area of excess debris

BEFORE DRILLING

STOP CHECK ALL MOUNTING LOCATIONS TO PREVENT PENETRATING GAS LINES, GAS TANKS, BRAKE LINES, WIRING OR ANY OTHER STRUCTURE OF VEHICLE **STOP**

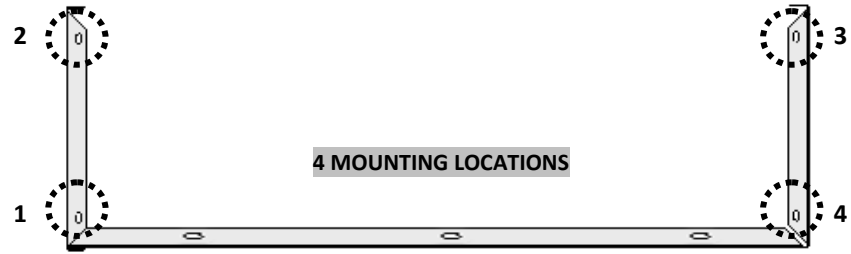

With module properly positioned attach module to floor of vehicle
Using either method described below.

NOTE: SPACER ONLY USED WHEN MOUNTING LOCATION FALL IN A VALLEY IN THE FLOOR

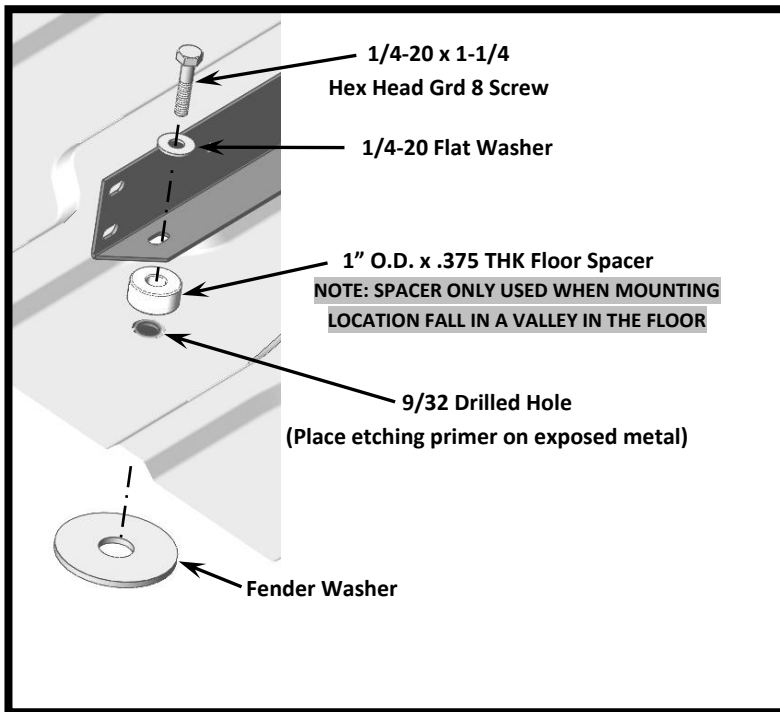

MOUNTING THROUGH FLOOR
(WHERE SPACE PERMITS UNDER VEHICLE)

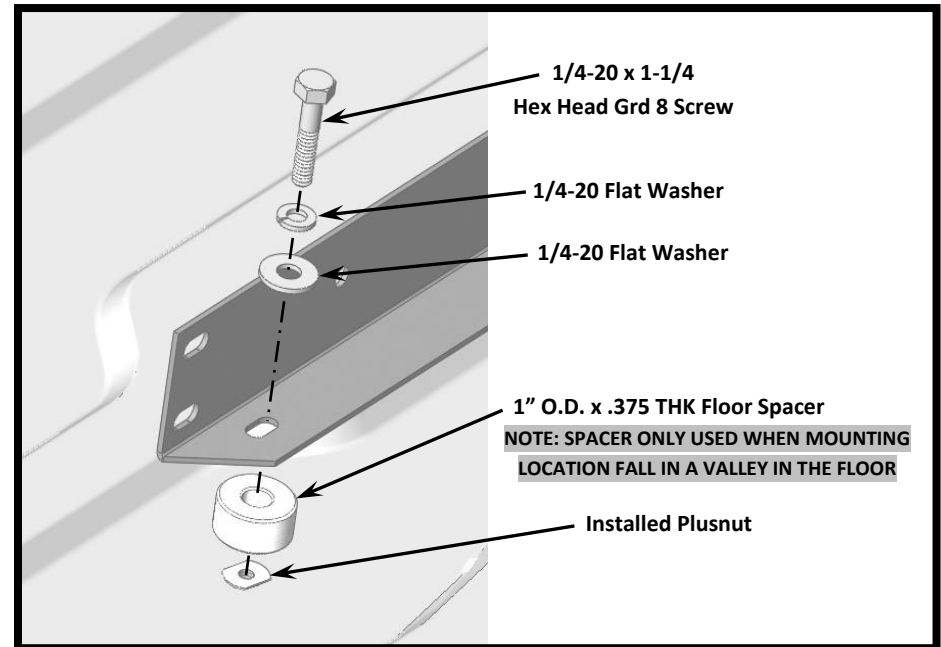

MOUNTING WITH PLUSNUT
(LIMITED SPACE UNDER VEHICLE)
(SEE PAGE 14 FOR PLUSNUT INSTALLATION)



BEFORE DRILLING



**CHECK ALL MOUNTING LOCATIONS TO PREVENT PENETRATING
GAS LINES, GAS TANKS, BRAKE LINES, WIRING OR ANY OTHER STRUCTURE OF VEHICLE**

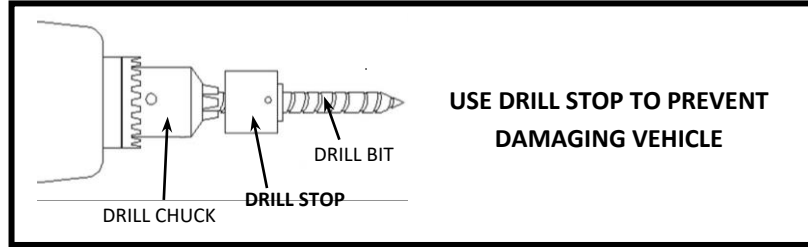

The Plusnut® is pre-bulbed for easy installation

1



The Plusnut® is pre-assembled with hex cap and hex bolt.
Then it is inserted into a pre-drilled hole

2

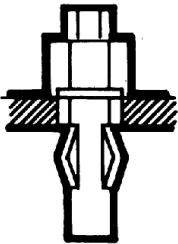

As the bolt is tightened, the Plusnut® upsets
and provides outstanding
blind fastening holding power

3

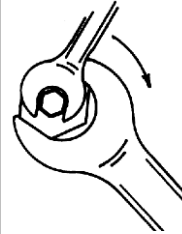

C-500 tool tightens bolt thru hex head cap into Plusnut® A
ratchet, open-end or closed –end wrench can be used.

4



Fully upset Plusnut® provides
a reliable nut plate for fastening.

5

CHECK EACH BOLT LOCATION

to ensure they are tightened to the specified
torque setting.



TORQUE SETTING:

Size – 1/4 GRD 5 = 7- 9.6 Ft.-Lbs.

Size – 1/4 GRD 8 = 10- 13.5 Ft.-Lbs.