

**Chevrolet Express / GMC Savana
135" Wheelbase
Plastic Liner Kit
With Ceiling And Insulation**



P.N.	DESCRIPTION	QTY
1	SAVANA 135" – DRIVER SIDE WALL LINER	1
2	SAVANA 135" – PASSENGER SIDE WALL LINER	1
3	SAVANA 135" – CEILING	1
4	SAVANA – CEILING TRIM PIECE	1
5	#8 X 3/4" DRILL POINT SCREW	14
6	SNAP CAP STEEL WASHER	14
7	PLASTIC SNAP CAP BLACK	14
8	CHRISTMAS TREE PLUG	15



**1100 Aviation Ave., Dieppe, NB, Canada E1A9A3
Ph: (506) 859-8591 Fax: (506) 857-1745**

DATE:
14 MAR 2012

SAVANA/EXPRESS 135" – PLASTIC LINER KIT WITH CEILING
MI-PUF613

2012©

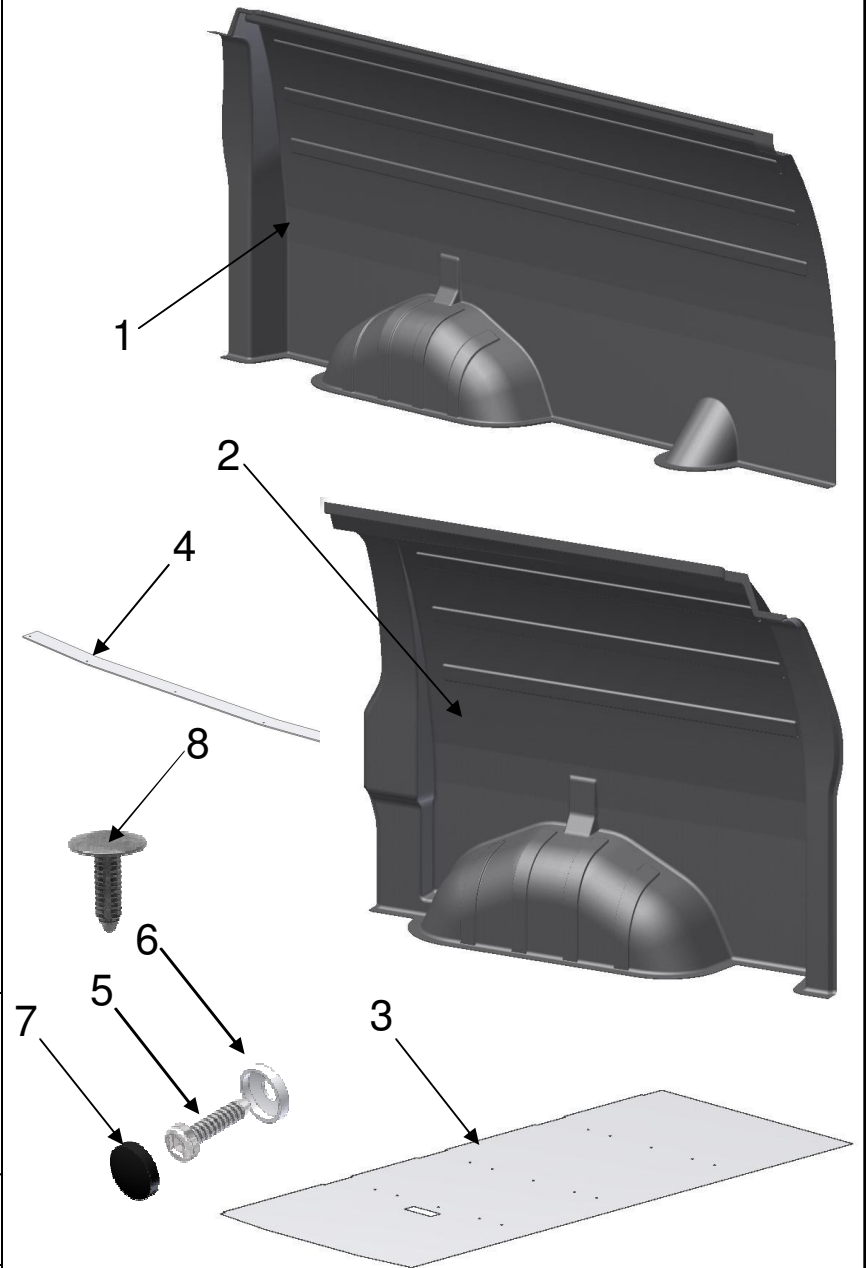

CARPET MODIFICATION

STEP 1

REMOVE REAR PLASTIC COVER.



STEP 2

REMOVE SIDE DOOR PLASTIC COVER AND REMOVE CARPET FROM THE VAN.



CARPET MODIFICATION

STEP 3

REMOVE FELT FROM RUBBER CARPET 2" ALL AROUND FOR THE DRIVER SIDE (LEFT OF PICTURE) AND TO THE FELT JOINT ON PASSENGER SIDE (RIGHT OF PICTURE) WHILE MAKING SURE NOT TO CUT THROUGH THE RUBBER CARPET.

AFTER THE MODIFICATION IS DONE REPLACE CARPET INTO THE VAN WITH THE COVERS REMOVED IN STEP 1 & 2.



PASSENGER SIDE LINER INSTALL

STEP 1

UNSCREW THE JACK BRACKET WING NUT FOLLOWED BY REMOVING JACK AND TIRE REMOVAL TOOLS.



STEP 2

COMPLETELY REMOVE JACK BRACKET BY UNSCREWING THESE 4 BOLTS USING 10 MM WRENCH.



PASSENGER SIDE LINER INSTALL

STEP 3

SLIDE PASSENGER SIDE WALL LINER THROUGH BACK DOORS.

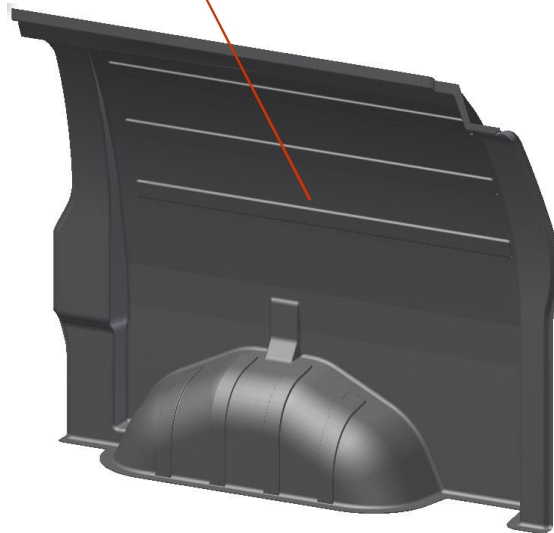

STEP 4

SLIDE JACK BRACKET STUD THROUGH EXISTING LINER HOLES.



PASSENGER SIDE LINER INSTALL

STEP 5

FASTEN PANEL USING #8 X 3/4" DRILL POINT SCREWS AND STEEL WASHERS AT THESE SIX LOCATIONS USING EXISTING HOLES. FINISH BY COVERING SCREWS WITH PLASTIC CAPS.

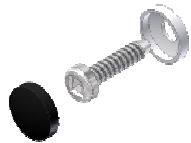
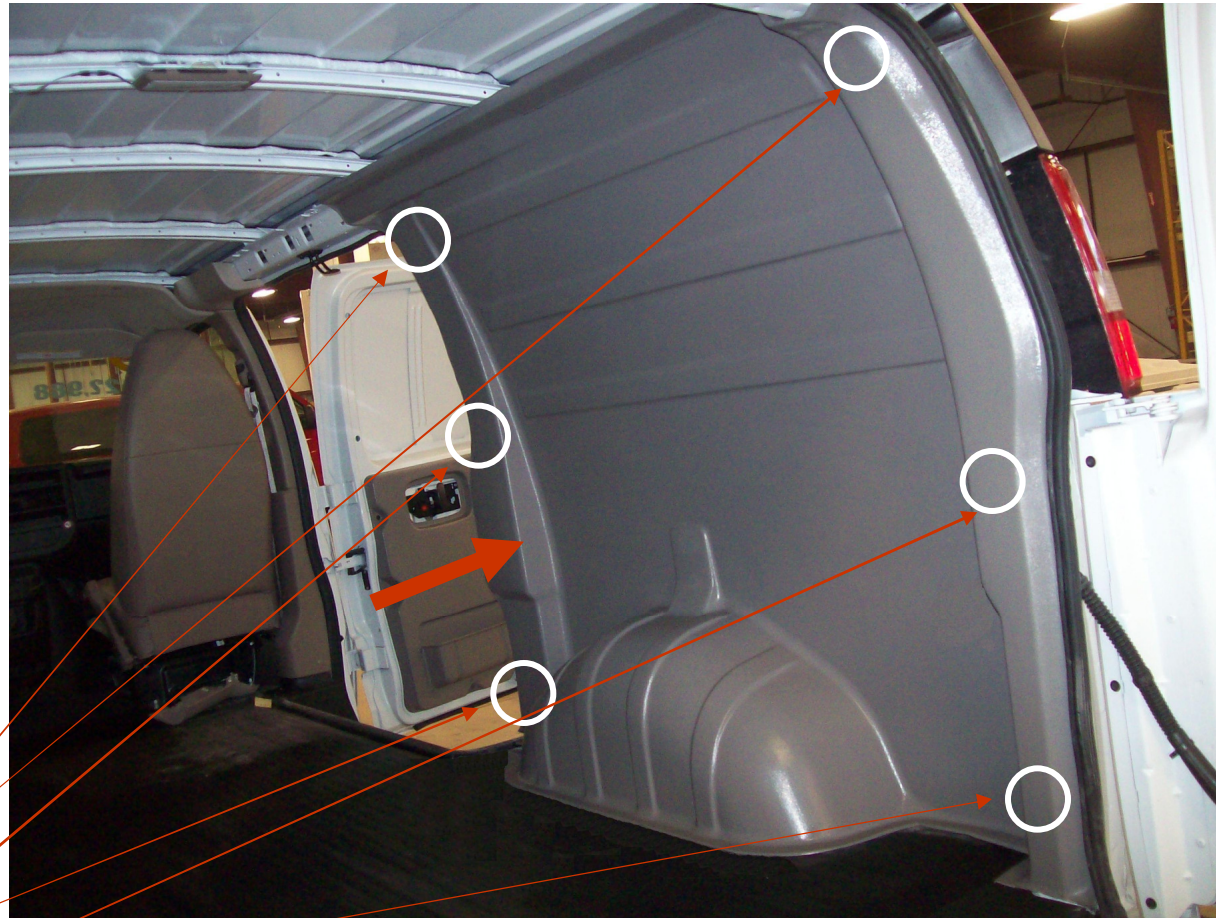

PASSENGER SIDE LINER INSTALL

STEP 6

REINSTALL JACK BRACKET WITH OEM FASTENERS USING EXISTING HOLES.



STEP 7

RE-INSTALL JACK AND TOOLS INTO BRACKET.



DRIVER SIDE LINER INSTALL

STEP 1



REMOVE OEM PLASTIC COVER ON DRIVER SIDE BY SIMPLY PULLING IT DOWNWARD.

STEP 2

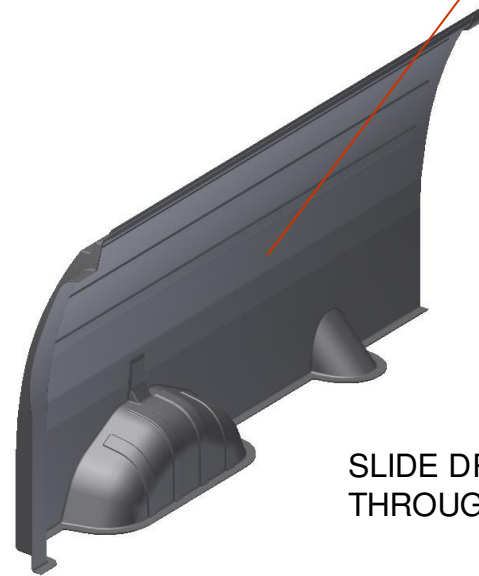

SLIDE DRIVER SIDE WALL LINER THROUGH THE BACK DOORS.



DRIVER SIDE LINER INSTALL

STEP 3

TUCK THIS END OF THE LINER BEHIND THE B-PILLAR PLASTIC COVERS.



STEP 4

PUSH THE LINER AGAINST THE VEHICULE.



DRIVER SIDE LINER INSTALL

STEP 5

FASTEN PANEL USING #8 X 3/4" DRILL POINT SCREWS AND STEEL WASHERS AT THESE THREE LOCATIONS USING EXISTING HOLES. FINISH BY COVERING SCREWS WITH PLASTIC CAPS.

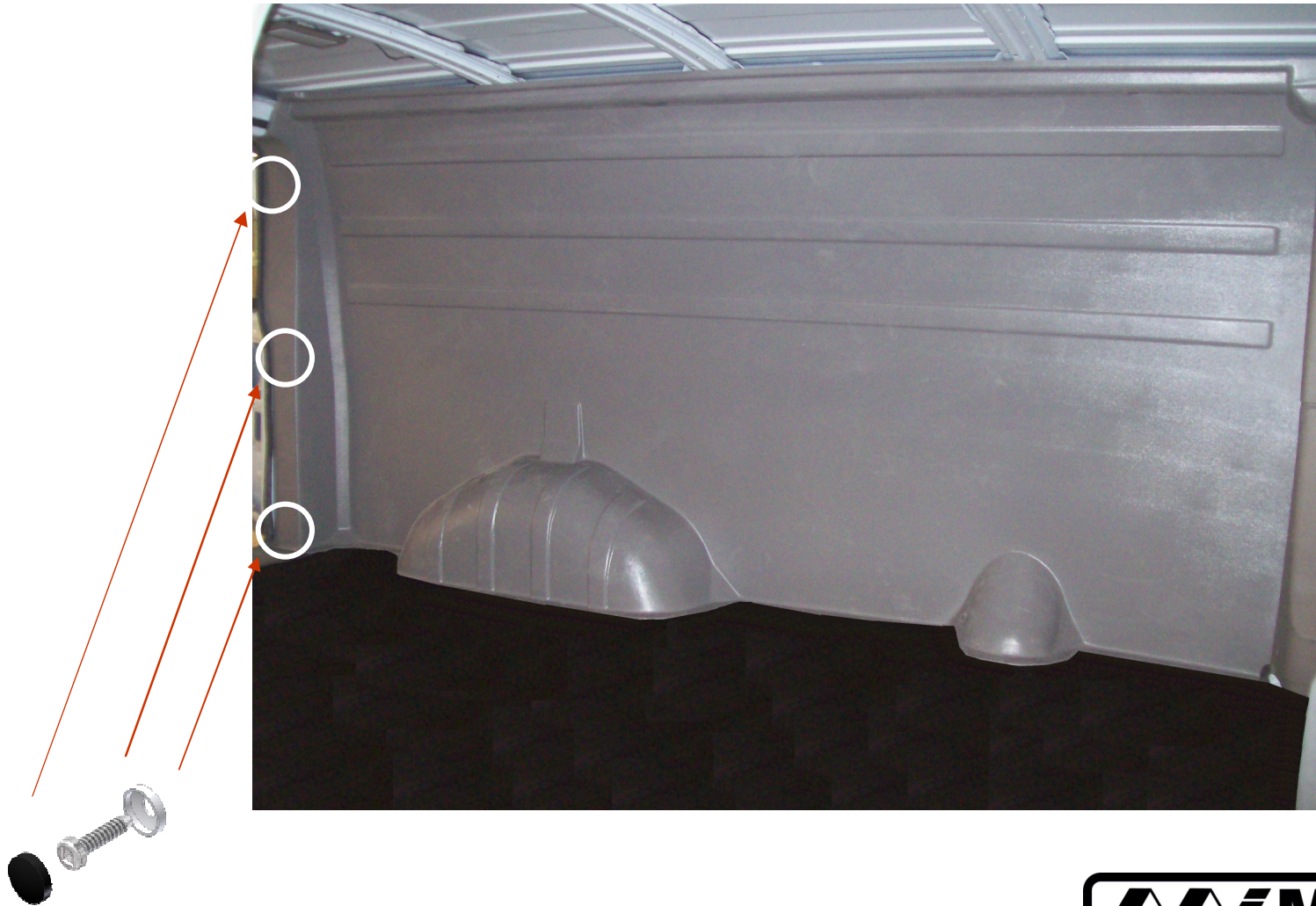

CEILING INSTALL

STEP 1

REMOVE DOME LIGHT PLASTIC COVER.
AND UNSCREW TWO PHILIPPS HEAD SCREW
AND REMOVE LIGHT.

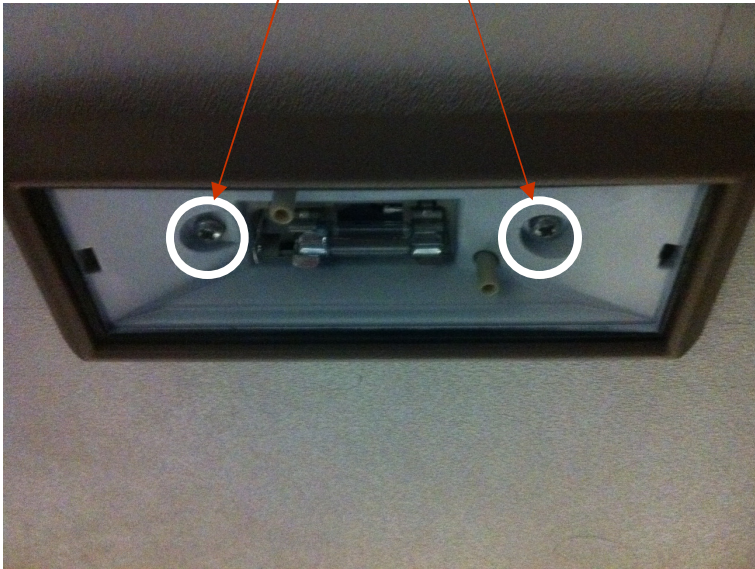

STEP 2

TUCK SIDE OF CEILING BETWEEN THE VAN
ROOF AND WALL LINER AND OVER HEADLINER.

INSTALL SUPPLIED CHRISTMAS TREE PLUG
USING EXISTING HOLES IN THE ROOF PANEL
WHERE SHOWN BELOW.

RE-INSTALL DOME LIGHT PLASTER COVERS

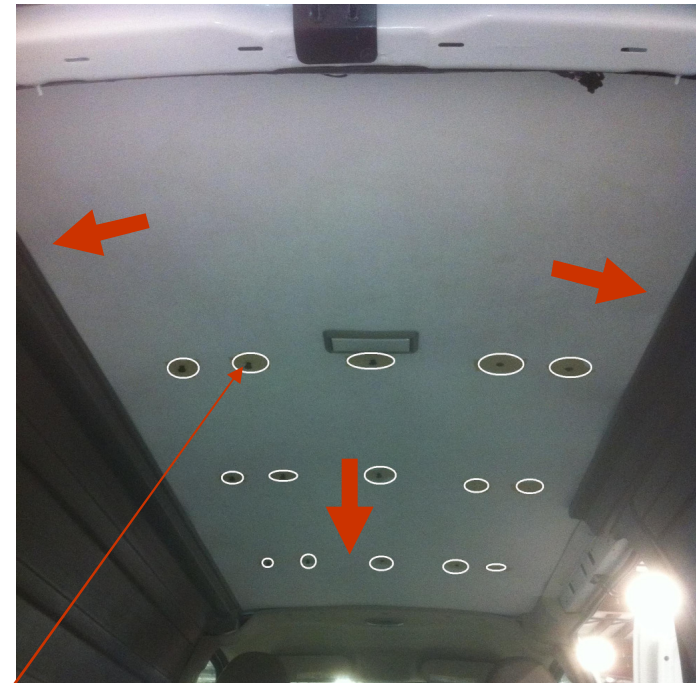

CEILING INSTALL

STEP 2

SCREW CEILING TRIM PIECE USING #8 X 3/4" DRILL POINT SCREWS AND STEEL WASHER AT FIVE LOCATIONS USING EXISTING HOLES.
FINISH BY COVERING SCREW WITH PLASTIC CAP.

