

ASSEMBLY / INSTALLATION INSTRUCTIONS

Recommended Tools

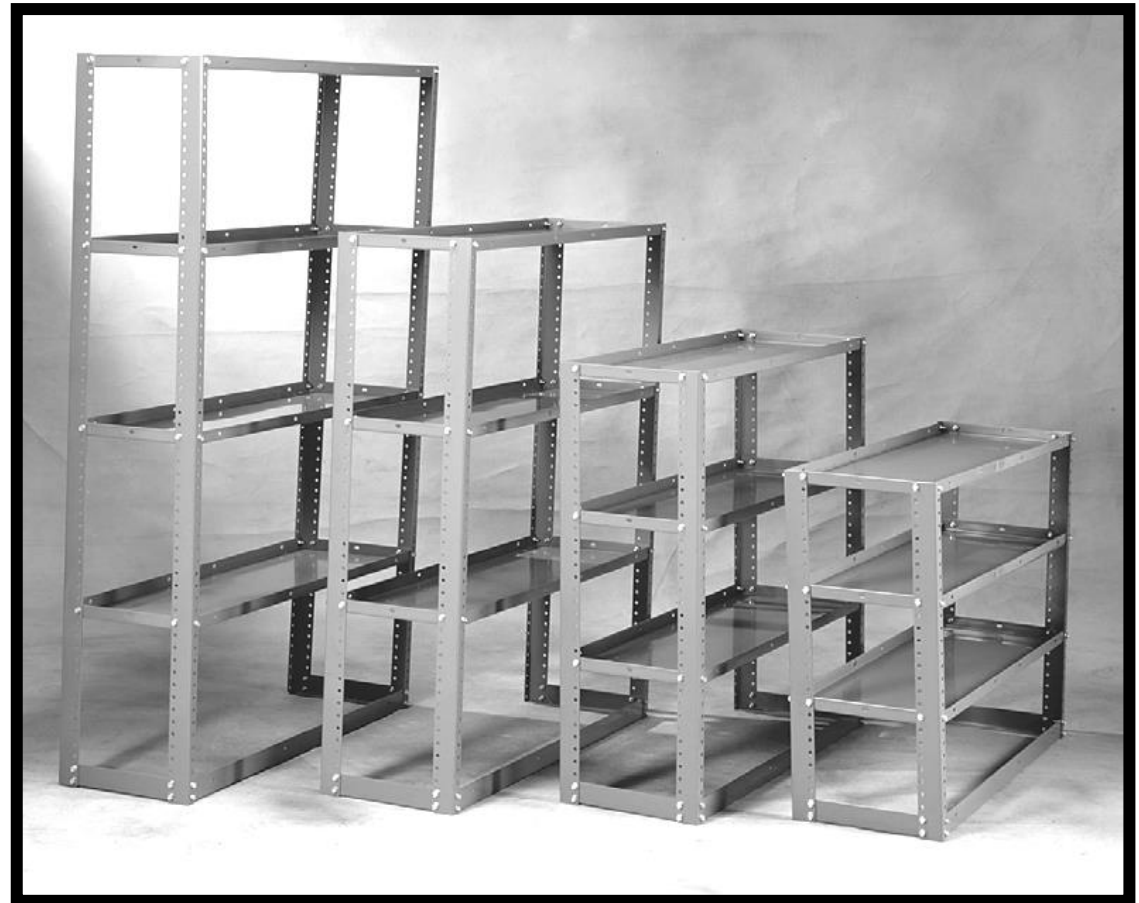

Hardware

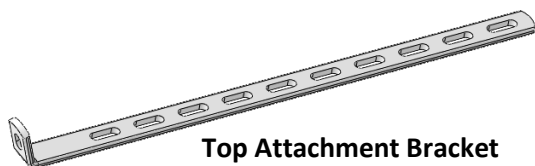
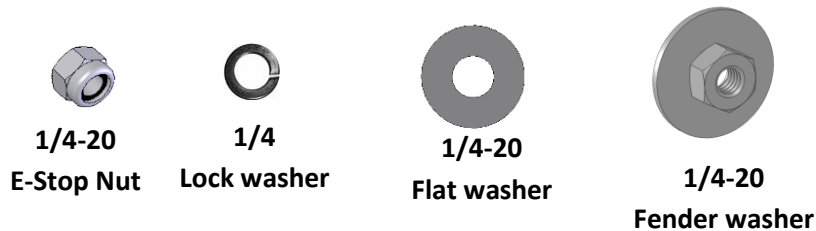
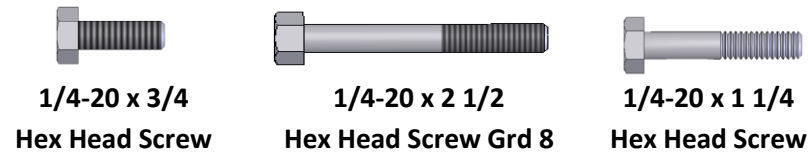

OPEN END SHELVING MODULES

Review this document to ensure that all parts and hardware are included in the package, before installation. In the event that parts are missing please contact Masterack @ 1-800-222-8785, to re-order missing parts.

EXPLODED VIEW

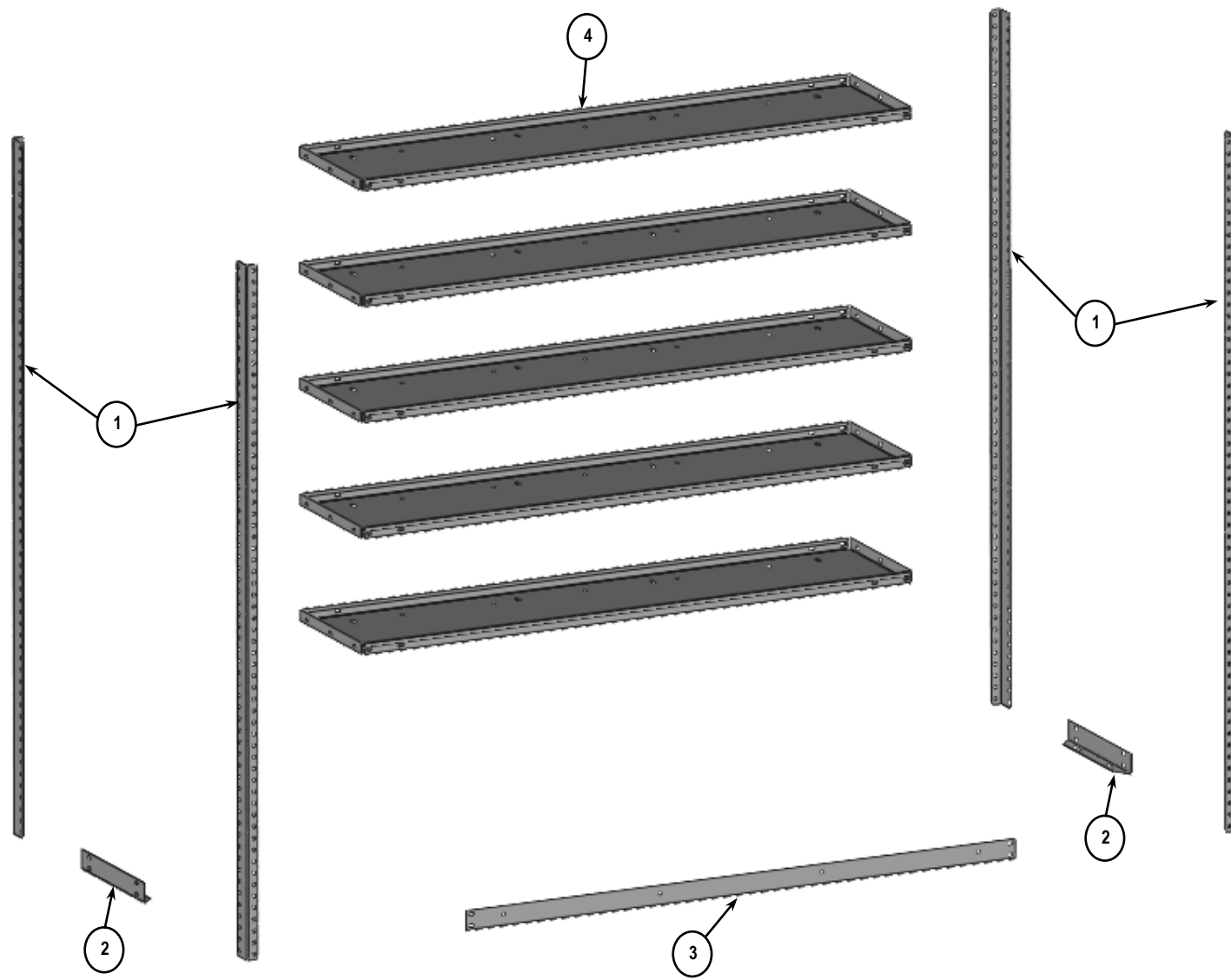

COMPONENTS

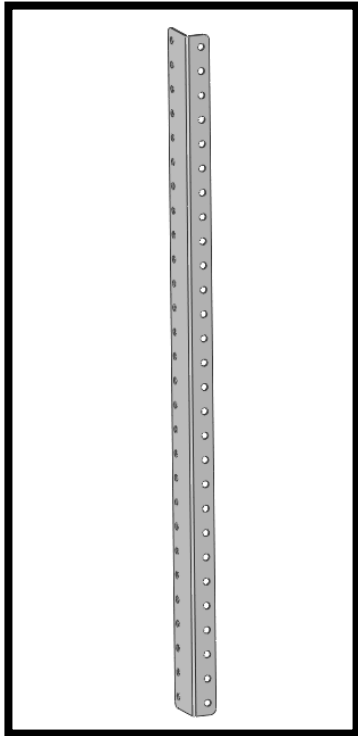

1 HEAVY DUTY UPRIGHT (SET OF 4)

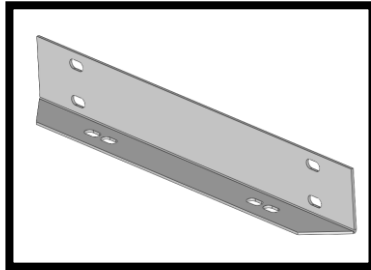

2 SIDE FLOOR BRACE (SET OF 2)

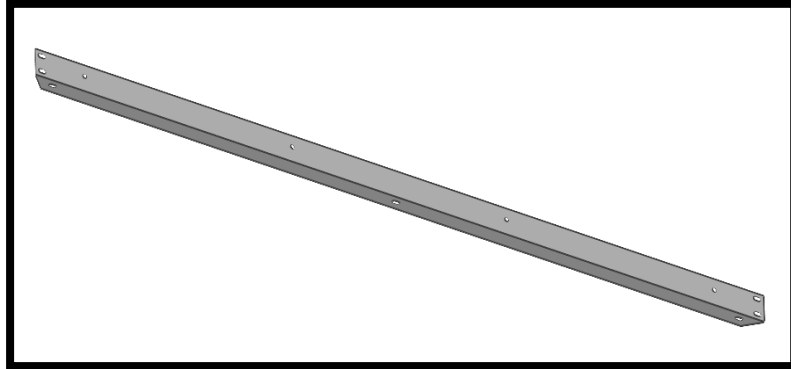

3 FRONT FLOOR BRACE

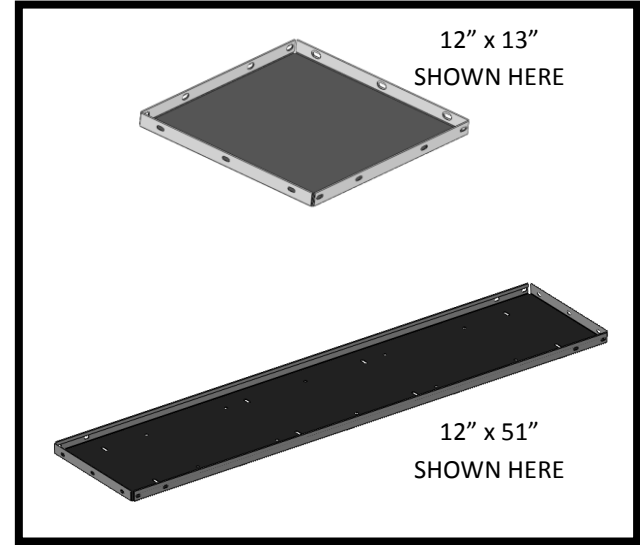

4 METAL SHELF

SHELVING MODULE	UPRIGHTS (SET OF 4) ①	SIDE FLOOR BRACE (SET OF 2) ②	FRONT FLOOR BRACE ③	METAL SHELF ④
021398KP [28H x 13W x 12D]	021368KP	023054KP [12"]		021377KP – QTY. 3
021421KP [36H x 13W x 12D]	021369KP	023054KP [12"]		021377KP – QTY. 3
021415KP [46H x 13W x 12D]	025366KP	023054KP [12"]		021377KP – QTY. 3
027517KP [60H x 13W x 12D]	026440KP	023054KP [12"]		021377KP – QTY. 5
021426KP [28H x 19W x 12D]	021368KP	023054KP [12"]	023055KP [19"]	021378KP – QTY. 3
021420KP [36H x 19W x 12D]	021369KP	023054KP [12"]	023055KP [19"]	021378KP – QTY. 3
021414KP [46H x 19W x 12D]	025366KP	023054KP [12"]	023055KP [19"]	021378KP – QTY. 3
027518KP [60H x 19W x 12D]	026440KP	023054KP [12"]	023055KP [19"]	021378KP – QTY. 5
021425KP [28H x 25W x 12D]	021368KP	023054KP [12"]	023056KP [25"]	021379KP – QTY. 3
021419KP [36H x 25W x 12D]	021369KP	023054KP [12"]	023056KP [25"]	021379KP – QTY. 3
021413KP [46H x 25W x 12D]	025366KP	023054KP [12"]	023056KP [25"]	021379KP – QTY. 3
026441KP [60H x 25W x 12D]	026440KP	023054KP [12"]	023056KP [25"]	021379KP – QTY. 5
021423KP [28H x 37W x 12D]	021368KP	023054KP [12"]	023058KP [37"]	021381KP – QTY. 3
021417KP [36H x 37W x 12D]	021369KP	023054KP [12"]	023058KP [37"]	021381KP – QTY. 3
021411KP [46H x 37W x 12D]	025366KP	023054KP [12"]	023058KP [37"]	021381KP – QTY. 3
027521KP [60H x 37W x 12D]	026440KP	023054KP [12"]	023058KP [37"]	021381KP – QTY. 5
021422KP [28H x 43W x 12D]	021368KP	023054KP [12"]	023059KP [43"]	021382KP – QTY. 3
021416KP [36H x 43W x 12D]	021369KP	023054KP [12"]	023059KP [43"]	021382KP – QTY. 3
021410KP [46H x 43W x 12D]	025366KP	023054KP [12"]	023059KP [43"]	021382KP – QTY. 3
027522KP [60H x 43W x 12D]	026440KP	023054KP [12"]	023059KP [43"]	021382KP – QTY. 5
027514KP [28H x 51W x 12D]	021368KP	023054KP [12"]	025680KP [51"]	025572KP – QTY. 3
027515KP [36H x 51W x 12D]	021369KP	023054KP [12"]	025680KP [51"]	025572KP – QTY. 3
027516KP [46H x 51W x 12D]	025366KP	023054KP [12"]	025680KP [51"]	025572KP – QTY. 3
027523KP [60H x 51W x 12D]	026440KP	023054KP [12"]	025680KP [51"]	025572KP – QTY. 5

SHELVING MODULE	UPRIGHTS (SET OF 4) 1	SIDE FLOOR BRACE (SET OF 2) 2	FRONT FLOOR BRACE 3	METAL SHELF 4
027525KP [36H x 19W x 16D]	021369KP	022613KP [16"]	023055KP [19"]	025153KP – QTY. 3
027532KP [46H x 19W x 16D]	025366KP	022613KP [16"]	023055KP [19"]	025153KP – QTY. 3
027539KP [60H x 19W x 16D]	026440KP	022613KP [16"]	023055KP [19"]	025153KP – QTY. 5
027526KP [36H x 25W x 16D]	021369KP	022613KP [16"]	023056KP [25"]	022816KP – QTY. 3
027533KP [46H x 25W x 16D]	025366KP	022613KP [16"]	023056KP [25"]	022816KP – QTY. 3
027540KP [60H x 25W x 16D]	026440KP	022613KP [16"]	023056KP [25"]	022816KP – QTY. 5
027527KP [36H x 31W x 16D]	021369KP	022613KP [16"]	023057KP [31"]	022398KP – QTY. 3
027534KP [46H x 31W x 16D]	025366KP	022613KP [16"]	023057KP [31"]	022398KP – QTY. 3
027541KP [60H x 31W x 16D]	026440KP	022613KP [16"]	023057KP [31"]	022398KP – QTY. 5
027528KP [36H x 37W x 16D]	021369KP	022613KP [16"]	023058KP [37"]	021381KP – QTY. 3
027535KP [46H x 37W x 16D]	025366KP	022613KP [16"]	023058KP [37"]	021381KP – QTY. 3
027542KP [60H x 37W x 16D]	026440KP	022613KP [16"]	023058KP [37"]	021381KP – QTY. 5
027529KP [36H x 43W x 16D]	021369KP	022613KP [16"]	023059KP [43"]	022396KP – QTY. 3
027536KP [46H x 43W x 16D]	025366KP	022613KP [16"]	023059KP [43"]	022396KP – QTY. 3
027543KP [60H x 43W x 16D]	026440KP	022613KP [16"]	023059KP [43"]	022396KP – QTY. 5
027530KP [36H x 51W x 16D]	021369KP	022613KP [16"]	025680KP [51"]	025571KP – QTY. 3
027537KP [46H x 51W x 16D]	025366KP	022613KP [16"]	025680KP [51"]	025571KP – QTY. 3
027544KP [60H x 51W x 16D]	026440KP	022613KP [16"]	025680KP [51"]	025571KP – QTY. 5
027549KP [46H x 37W x 22D]	025366KP	025335KP [22"]	023058KP [37"]	025319KP – QTY. 3
027556KP [60H x 37W x 22D]	026440KP	025335KP [22"]	023058KP [37"]	025319KP – QTY. 5
027550KP [46H x 43W x 22D]	025366KP	025335KP [22"]	023058KP [37"]	025319KP – QTY. 3
027557KP [60H x 43W x 22D]	026440KP	025335KP [22"]	023058KP [37"]	025319KP – QTY. 5
027551KP [46H x 43W x 22D]	025366KP	025335KP [22"]	023058KP [37"]	025319KP – QTY. 3
027558KP [60H x 43W x 22D]	026440KP	025335KP [22"]	023058KP [37"]	025319KP – QTY. 5

ASSEMBLING UPRIGHTS

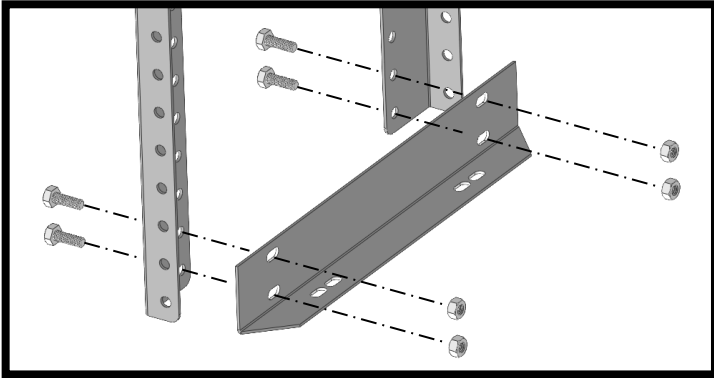

Assemble as shown using:
(4) 1/4-20 x 3/4 Hex Head Screws
(4) 1/4-20 E-Stop Nuts

TORQUE SETTING:
Size - 1/4 = 7 - 9.5 Ft.-Lbs.

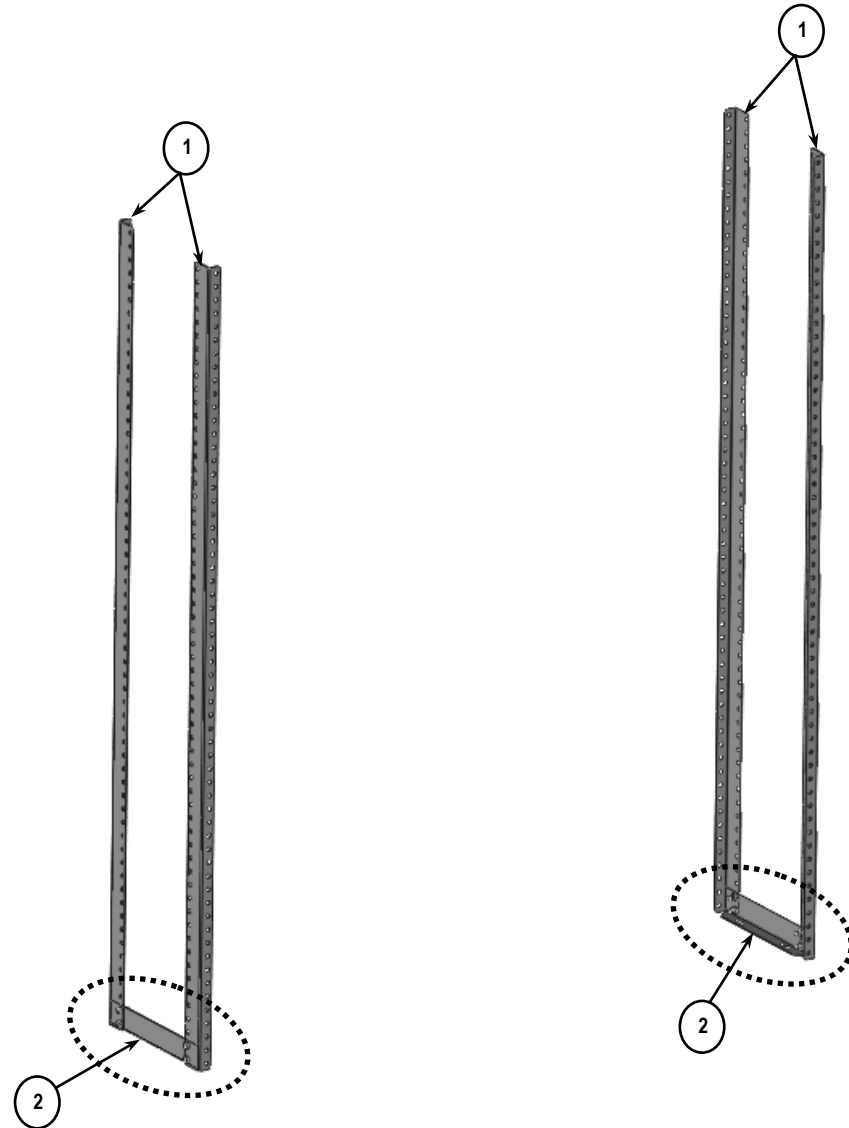
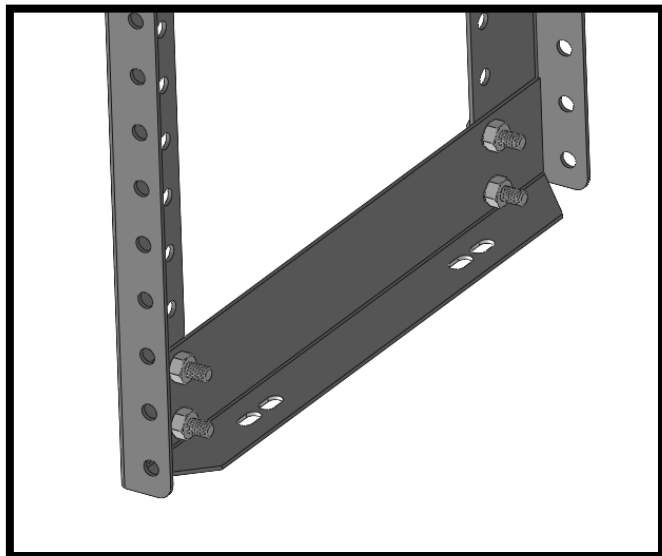

ATTACHING FRONT FLOOR BRACE

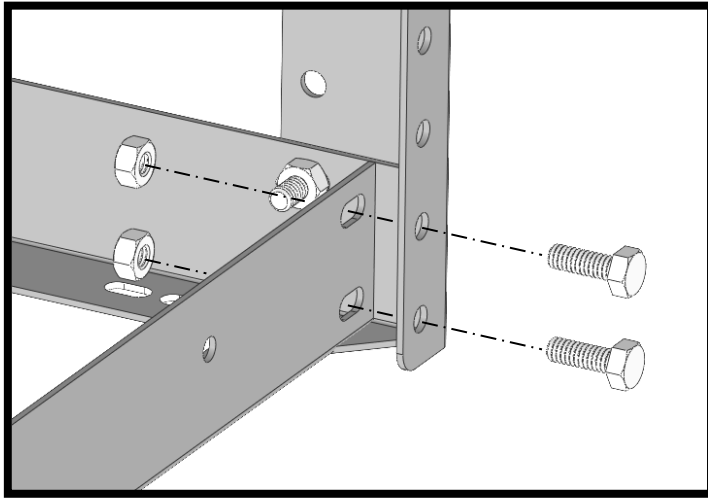

- Attach as shown using:
- (4) 1/4-20 x 3/4 Hex Head Screws
 - (4) 1/4-20 E-Stop Nuts

TORQUE SETTING:
Size – 1/4 = 7 – 9.5 Ft.-Lbs.

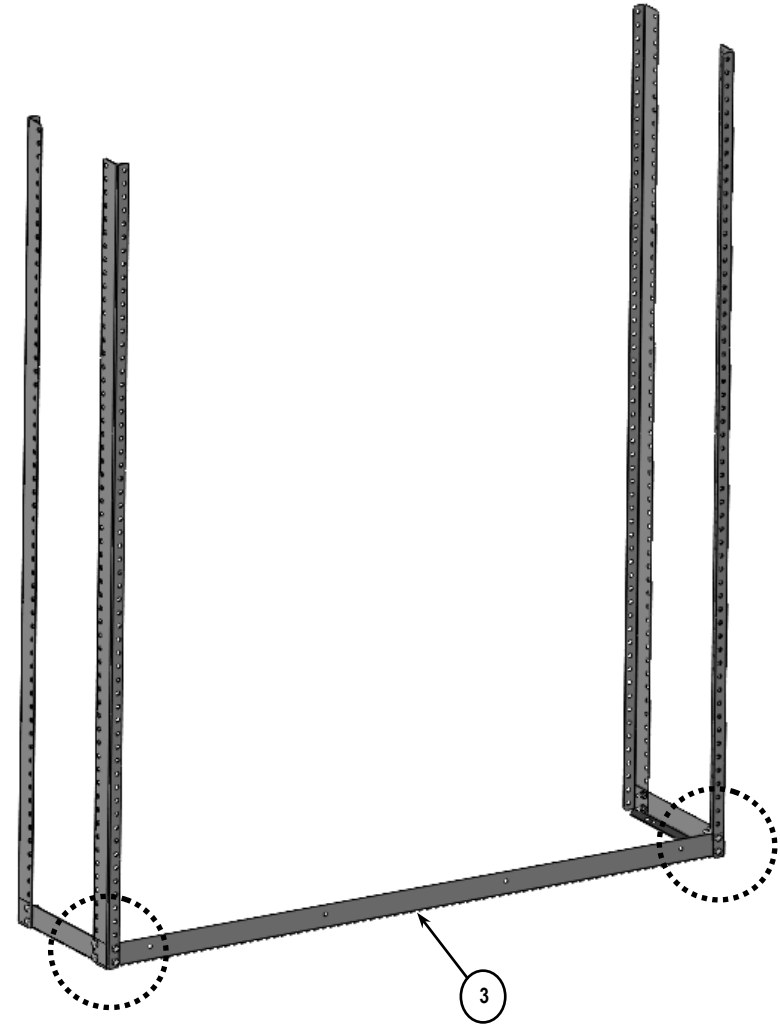

ATTACHING BOTTOM SHELF

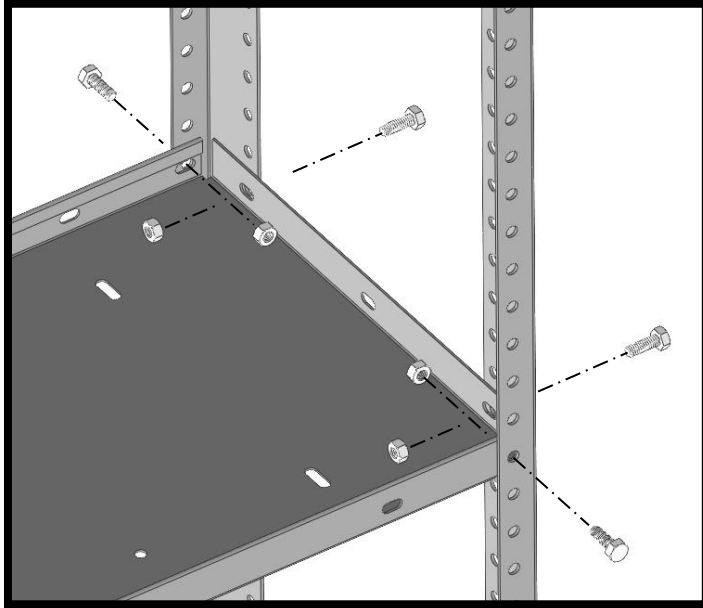

Attach as shown using:
(8) 1/4-20 x 3/4 Hex Head Screws
(8) 1/4-20 E-Stop Nuts

TORQUE SETTING:
Size - 1/4 = 7 - 9.5 Ft.-Lbs.

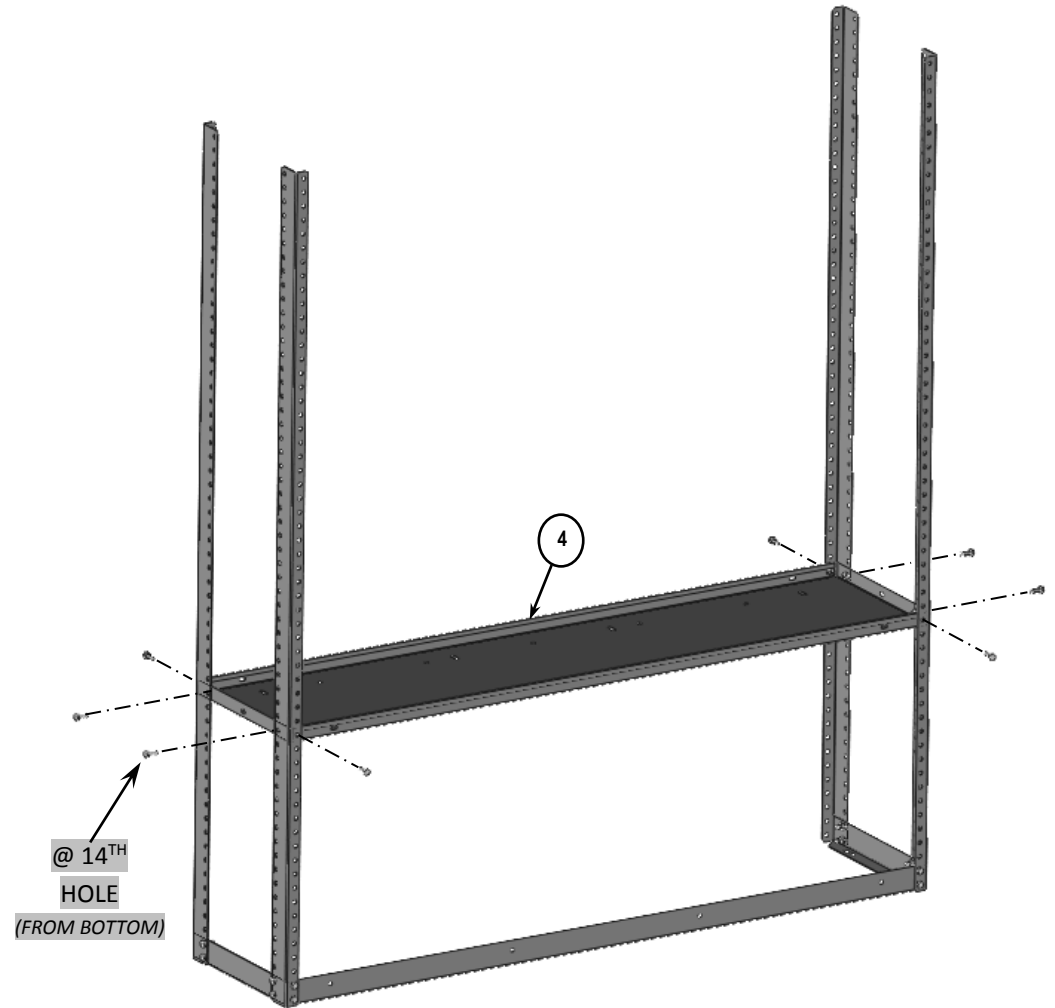

ATTACHING REMAINING SHELVES

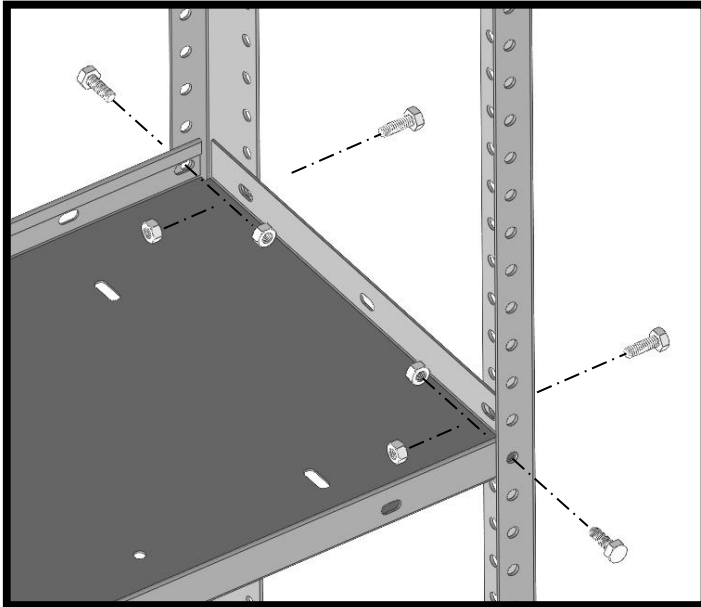

Attach as shown using:
(8) 1/4-20 x 3/4 Hex Head Screws
(8) 1/4-20 E-Stop Nuts

PER SHELF

TORQUE SETTING:
Size - 1/4 = 7 - 9.5 Ft.-Lbs.

NOTE:
SHELVES ARE ADJUSTABLE TO FIT REQUIRED NEED.
MOUNTING LOCATIONS SHOWN ARE STANDARD
MOUNTING LOCATIONS 10 INCHES APART.

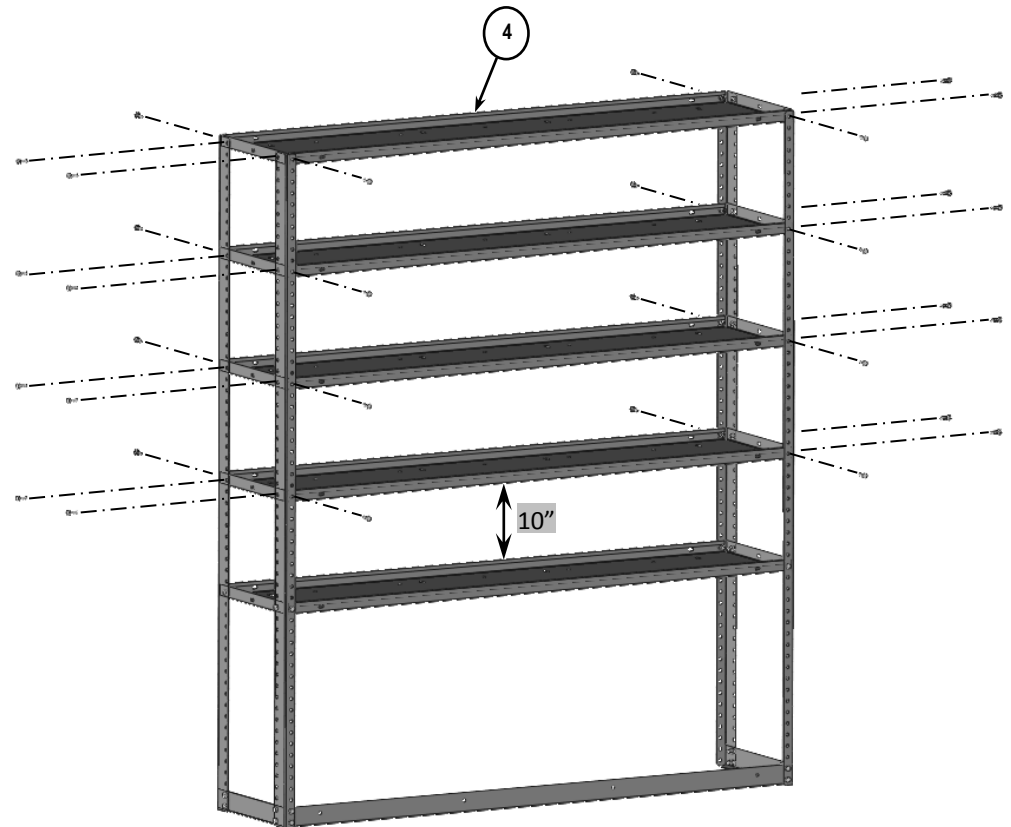

STANDARD INSTALLATION

BEFORE DRILLING

STOP CHECK ALL MOUNTING LOCATIONS TO PREVENT PENETRATING GAS LINES, GAS TANKS, BRAKE LINES, WIRING OR ANY OTHER STRUCTURE OF VEHICLE **STOP**

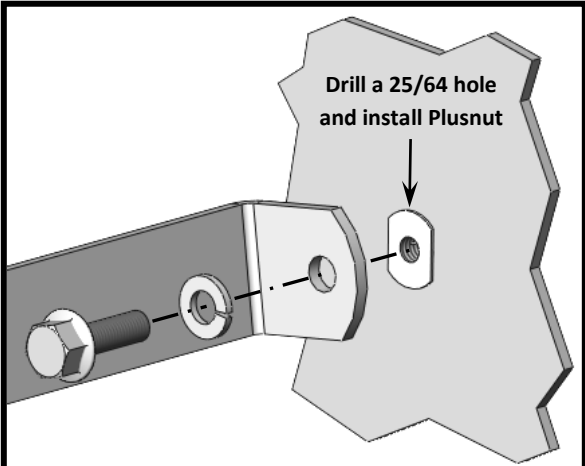

Drill a 25/64 hole and install Plusnut

With module properly positioned in desired location in vehicle, attach brackets loosely at the locations shown. Mark and drill 25/64 holes to install Plusnuts and secure as shown using:

- (1) 1/4-20 x 1 1/4 Hex Head Screws
- (1) 1/4-20 Lock Washer

AT EACH MOUNTING LOCATON

TORQUE SETTING:
Size - 1/4 = 7 - 9.5 Ft.-Lbs.

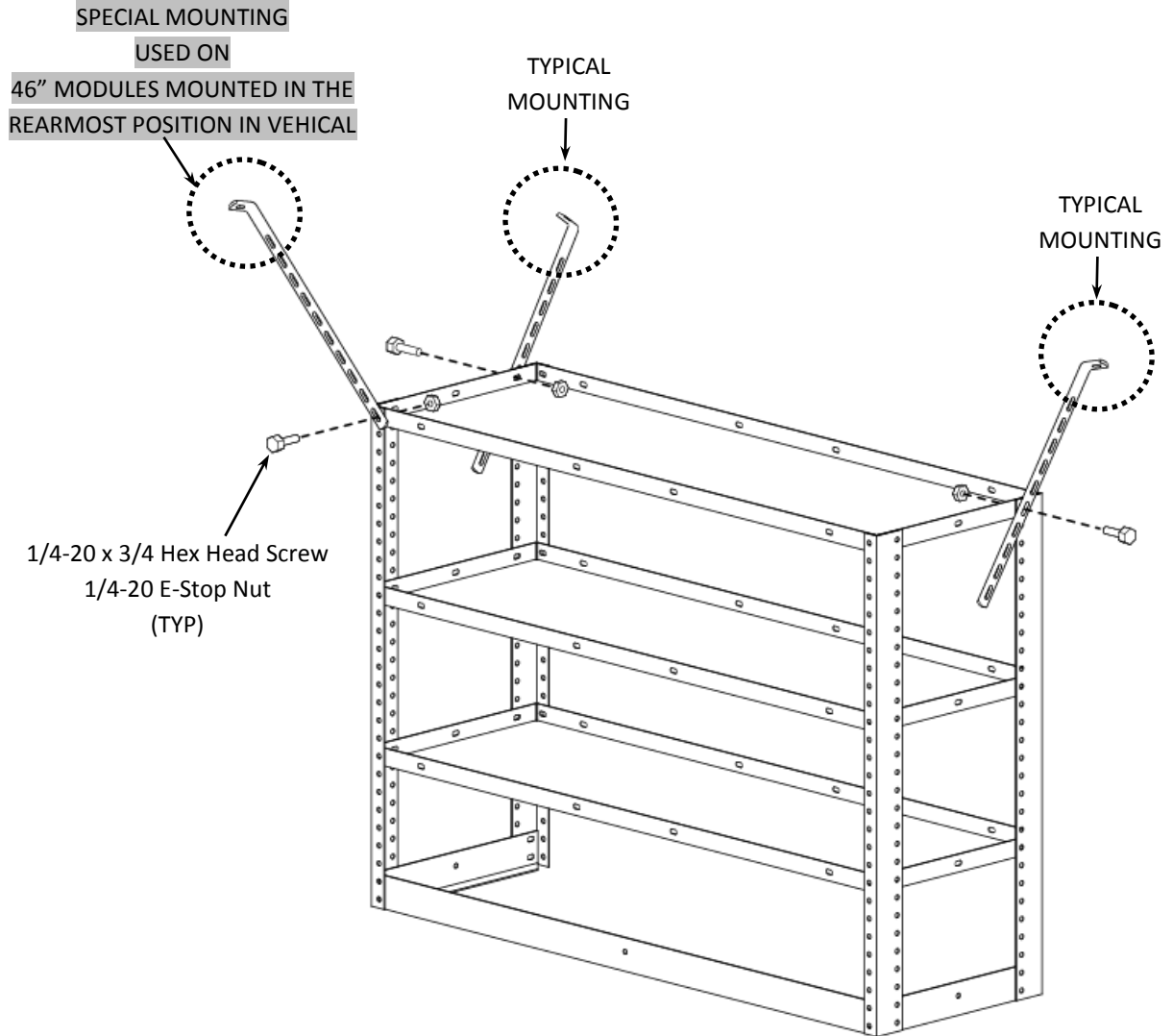

STANDARD INSTALLATION

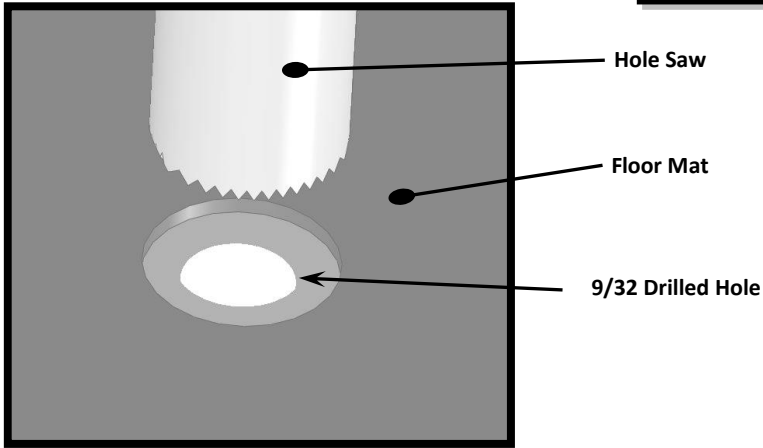

NOTE:

Using a 1-1/8" Hole Saw specially made for mat cutting, hole saw out all holes in the mat making sure to align hole saw with pre drilled holes. **Make sure not to drill through the metal floor of the van.** Once drilled clear out each area of excess debris

BEFORE DRILLING

STOP CHECK ALL MOUNTING LOCATIONS TO PREVENT PENETRATING GAS LINES, GAS TANKS, BRAKE LINES, WIRING OR ANY OTHER STRUCTURE OF VEHICLE **STOP**

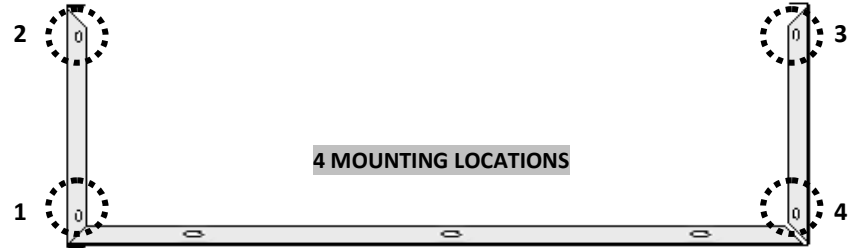

With module properly positioned attach module to floor of vehicle
Using either method described below.

NOTE: SPACER ONLY USED WHEN MOUNTING LOCATION FALL IN A VALLEY IN THE FLOOR

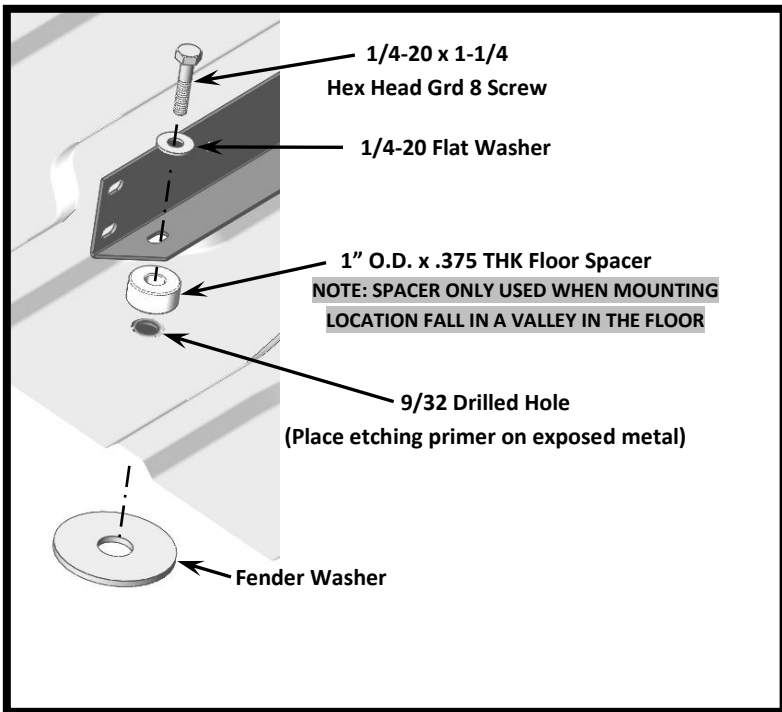

MOUNTING THROUGH FLOOR
(WHERE SPACE PERMITS UNDER VEHICLE)

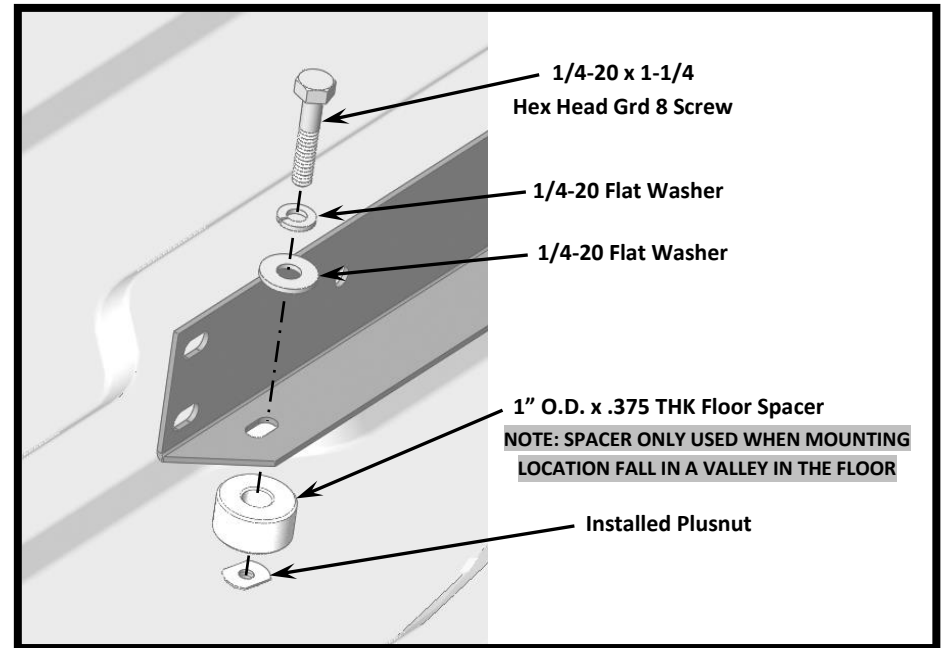

MOUNTING WITH PLUSNUT
(LIMITED SPACE UNDER VEHICLE)
(SEE PAGE 12 FOR PLUSNUT INSTALLATION)

BEFORE DRILLING

STOP **STOP**

**CHECK ALL MOUNTING LOCATIONS TO PREVENT PENETRATING
GAS LINES, GAS TANKS, BRAKE LINES, WIRING OR ANY OTHER STRUCTURE OF VEHICLE**

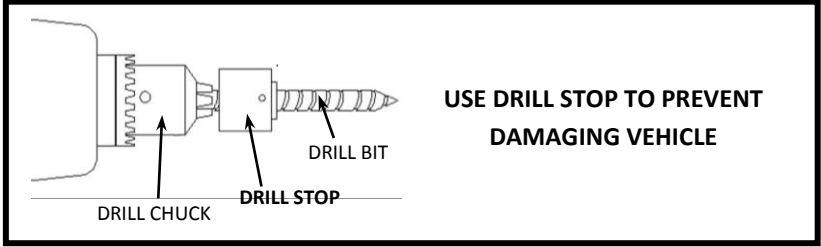

The Plusnut® is pre-bulbed for easy installation

1

The Plusnut® is pre-assembled with hex cap and hex bolt.
Then it is inserted into a pre-drilled hole

2

As the bolt is tightened, the Plusnut® upsets
and provides outstanding
blind fastening holding power

3

C-500 tool tightens bolt thru hex head cap into Plusnut® A
ratchet, open-end or closed –end wrench can be used.

4

Fully upset Plusnut® provides
a reliable nut plate for fastening.

5

CHECK EACH BOLT LOCATION
to ensure they are tightened to the specified
torque setting.

TORQUE SETTING:
Size – 1/4 GRD 5 = 7- 9.6 Ft.-Lbs.
Size – 1/4 GRD 8 = 10- 13.5 Ft.-Lbs.

3 Year / 36,000 Mile Limited Warranty

MASTERACK® commercial van and pickup equipment is warranted to be from defects in material and workmanship, under normal use and service for a period of one (1) year from date of purchase. Factory installations, and products installed in new vehicles by an authorized MASTERACK® installer are warranted for **(3) years or 36,000 miles (60,000 KM)**, whichever comes first. **This warranty covers only repairs, or at MASTERACKS' discretion, replacement to correct any defects related to materials and workmanship.**

This warranty does not apply to:

- Additions, alterations, or installations made by persons including dealers, other than MASTERACK® and its authorized distributors, made in accordance with MASTERACK® specifications and / or instructions, nor to defects arising out of attribute to such additions, alterations or installations.
- Defects attributable to abuse or misuse of the product, misapplication, negligent accident, modification or tampering.
- Damage resulting from failure to promptly notify and comply with the instructions of the dealer or manufacturer about defects when noted.
- Any incidental or consequential damages connected with a defect, either while under warranty or afterward, including the cost of a rental truck and / or loss or revenue.

THE WARRANTY IS THE ONLY WARRANTY APPLICABLE TO A MASTERACK PRODUCT PURCHASE. ALL OTHER WARRANTIES, EXPRESSED OR IMPLIED, INCLUDING BUT NOT LIMITED TO, THE IMPLIED WARRANTIES OR MERCHANTABILITY AND FITNESS FOR A PARTICULAR PURPOSE ARE DISCLAIMED. MASTERACK® AND ITS SUBSIDIARIES, SHALL NOT BE LIABLE FOR ANY INCIDENTAL OR CONSEQUENTIAL DAMAGES ARISING OUT OF ANY BREACH OF THIS WARRANTY, NOR SHALL THE DAMAGES EXCEED THE RETURN AMOUNT OF THE PURCHASE PRICE PAID BY THE ORIGINAL PURCHASER.

Warranty claims must be submitted to either your sales representative or a customer service representative at **1-800-222-8785**. The vehicle must be delivered to the original MASTERACK® authorized dealer for inspection and any warranty service. Any warranty service to be performed by a source other than MASTERACK® location or an approved MASTERACK® distributor must be authorized in advance of the repairs by the MASTERACK® Warranty Administrator and a purchase order issued by MASTERACK® in advance or repairs for the authorized repairs.